

ST-26 BRIDGELAYER

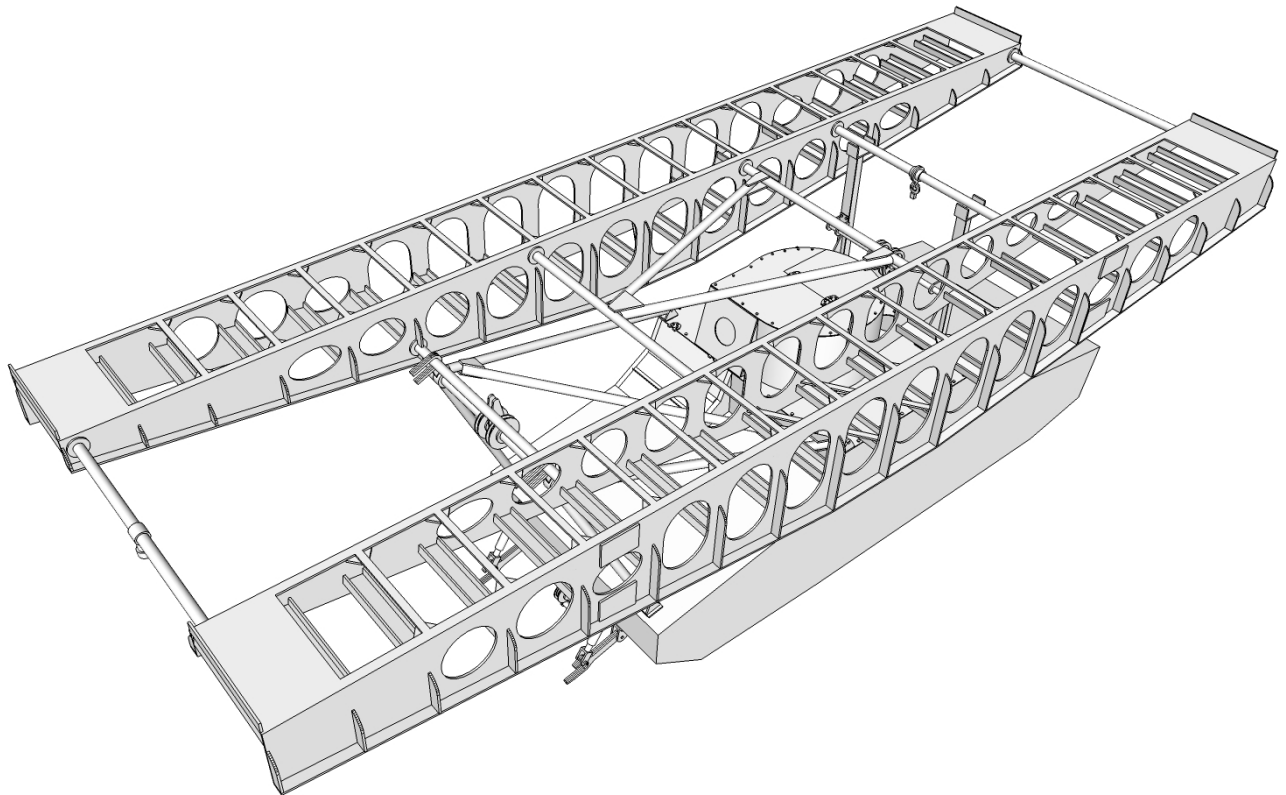

Photoetch Conversion Set for HobbyBoss Kit No. 82494

Kit Contents

Fret A

Fret B

Brass Rods, Tubes & Other Parts

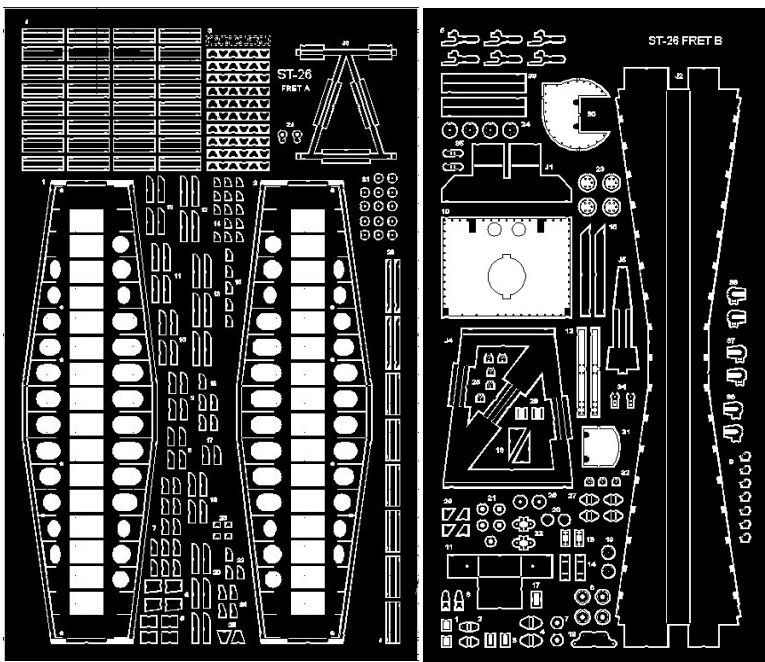

Item	CUT LENGTH	QTY
1.5mm Rod	39	6
	47	2
	55	2
	60	1
	37	3
	2	1
2mm Tube	16	1
	34	1
	12	1
1mm Rod	2	3
	2	1
	28	1
0.5mm Rod	8	2
	20	1
1.5mm Tube	4	2
	2	1
3mm Tube	1.5	4
00-90 Hex Nuts	-	2
0.4mm Solder	-	1

Base kit can be built before starting, with the exception of parts:

- F8
- F24
- Both turrets

2

Rung Alignment Jig

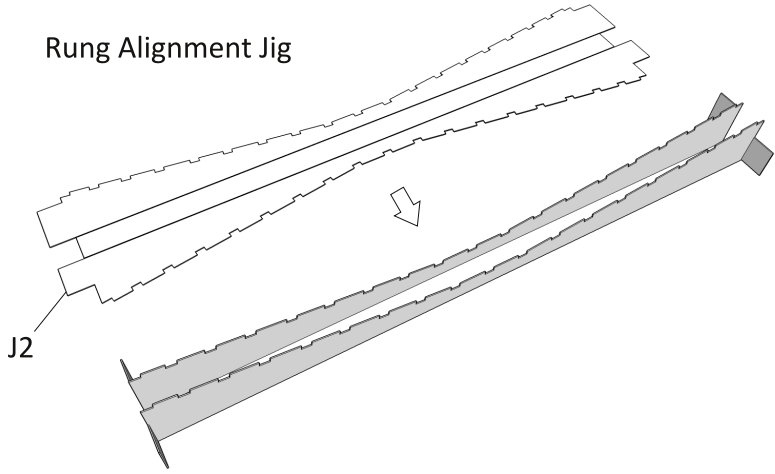

1

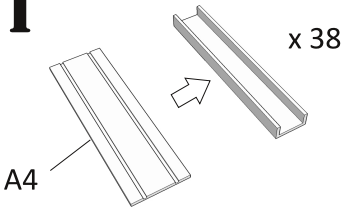

3

Left Bridge

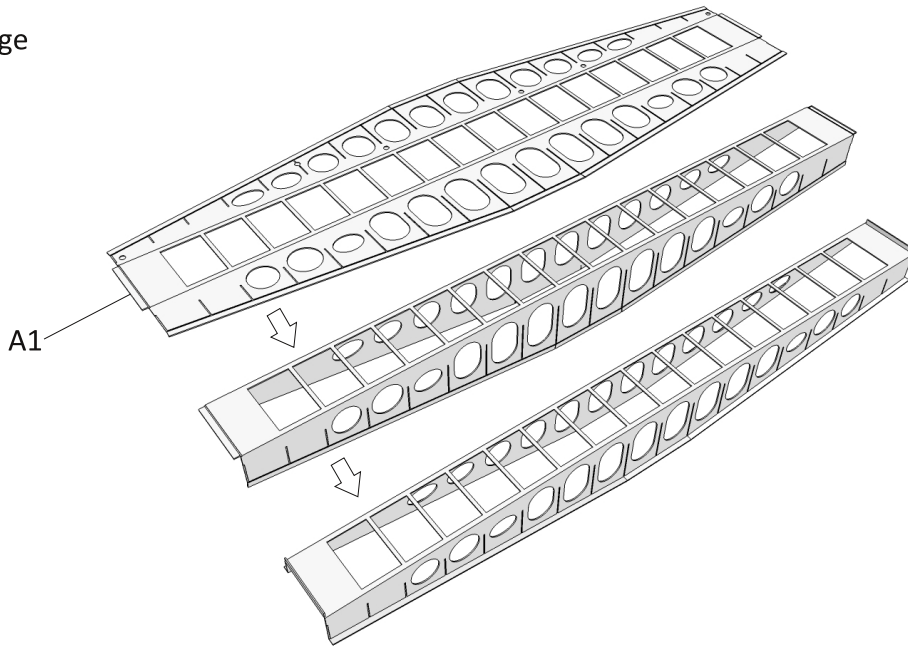

4

Right Bridge

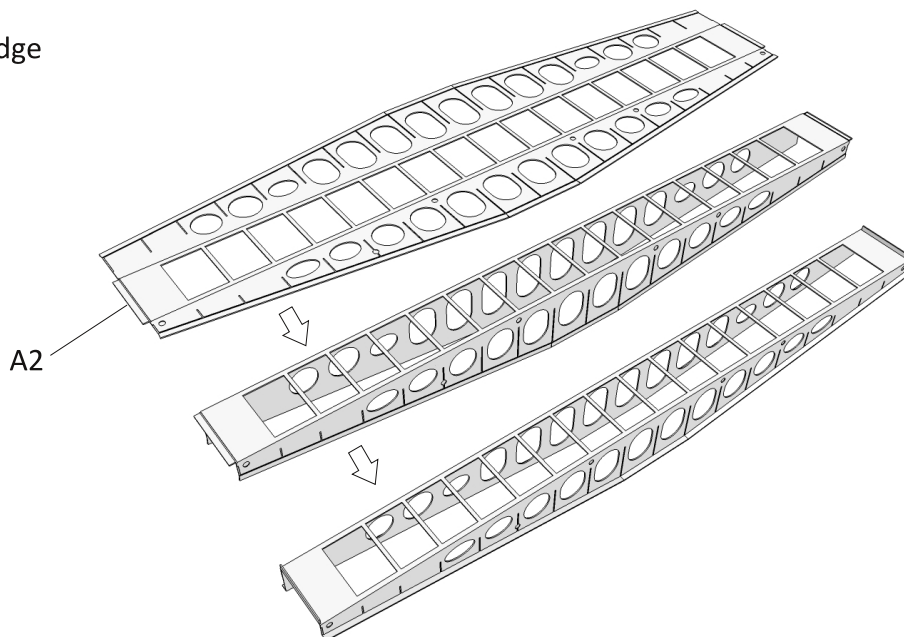

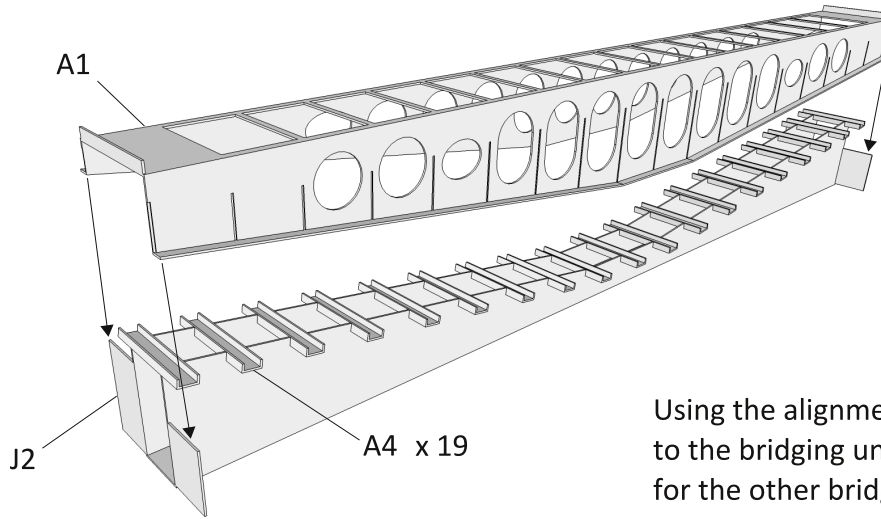
5

Using the alignment jig, attach the rungs (A4) to the bridging unit (A1), repeat the process for the other bridging unit (A2).

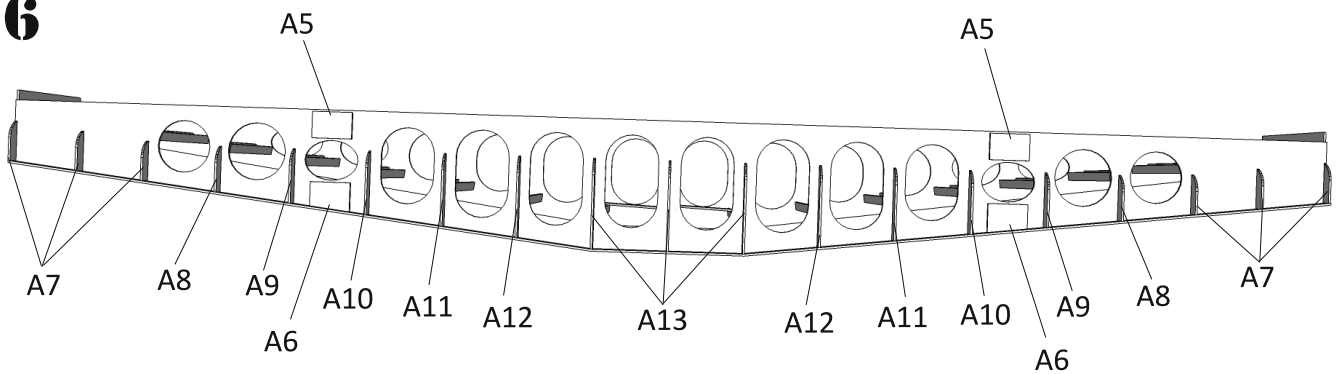
6

Looking at the outside face. Repeat for both left and right bridging units (A1 & A2).

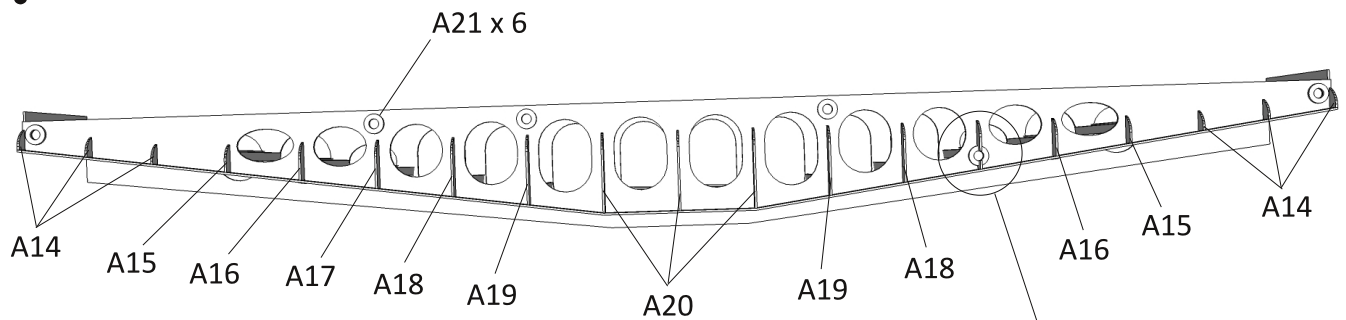
7

Looking at the inside face. Repeat for both left and right bridging units (A1 & A2).

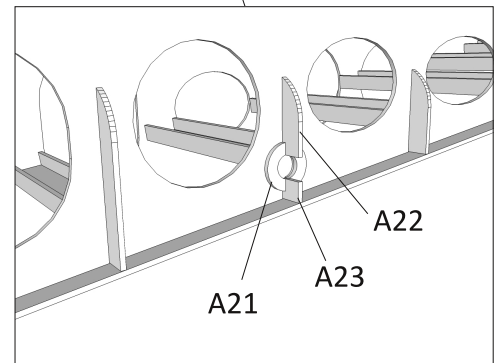
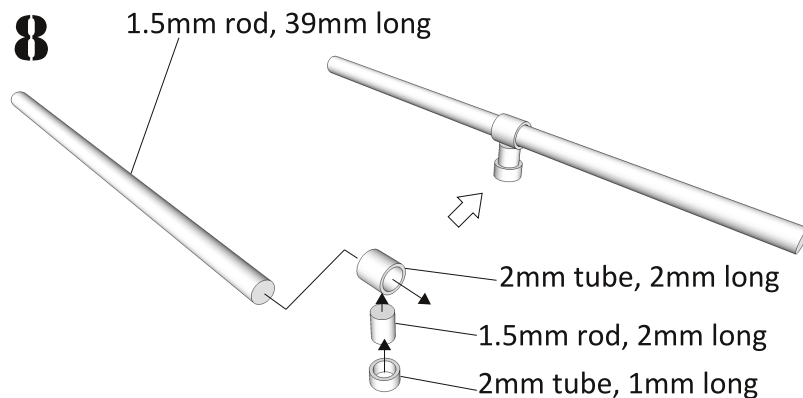
8

9

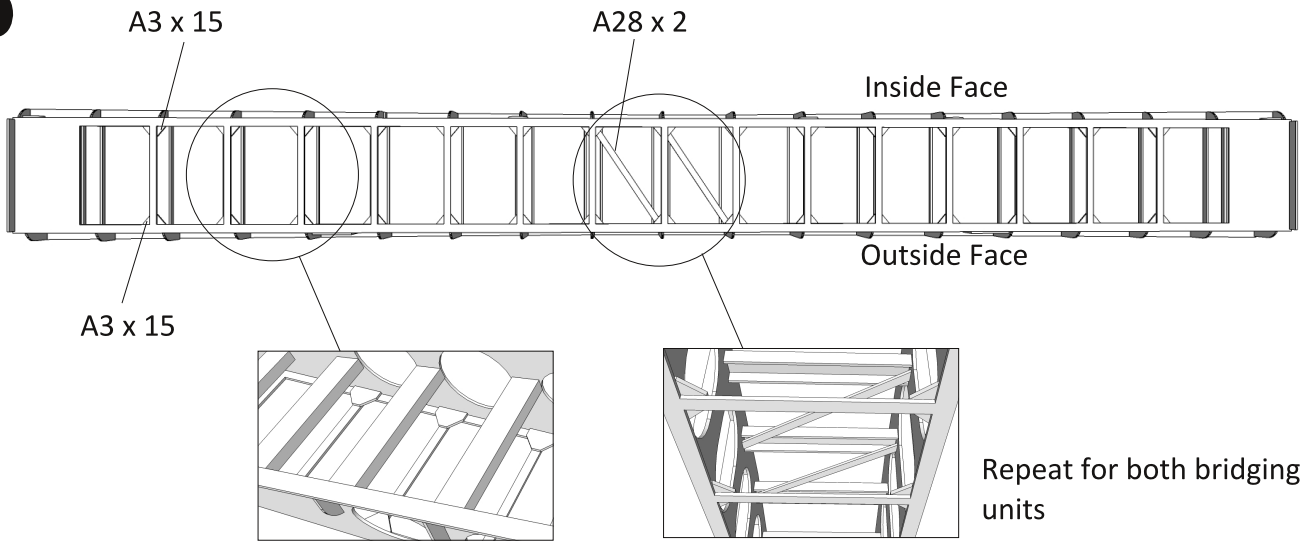

10

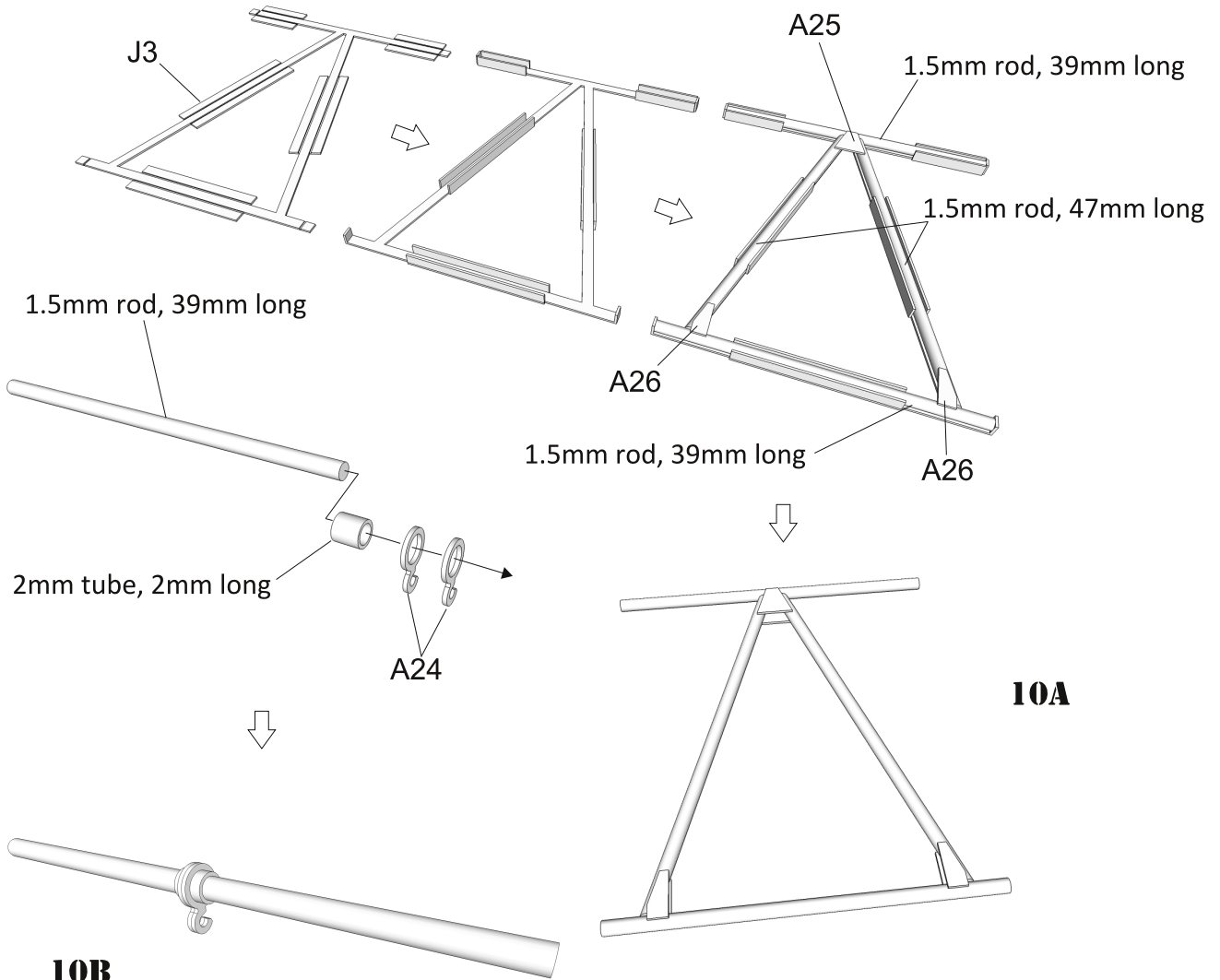

Remove cross member assembly from jig, flip and repeat placement of parts A25 & A26

11

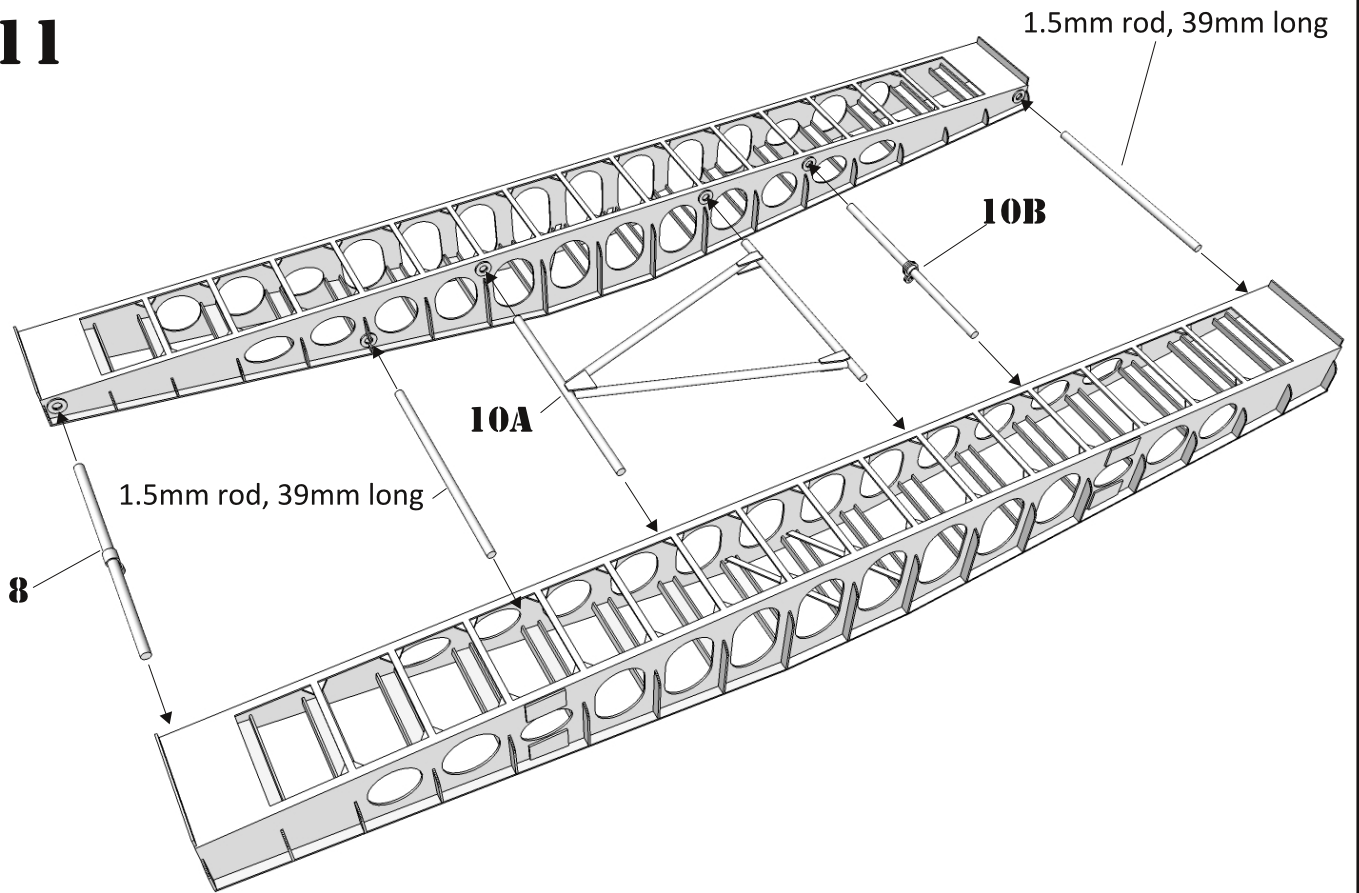

12

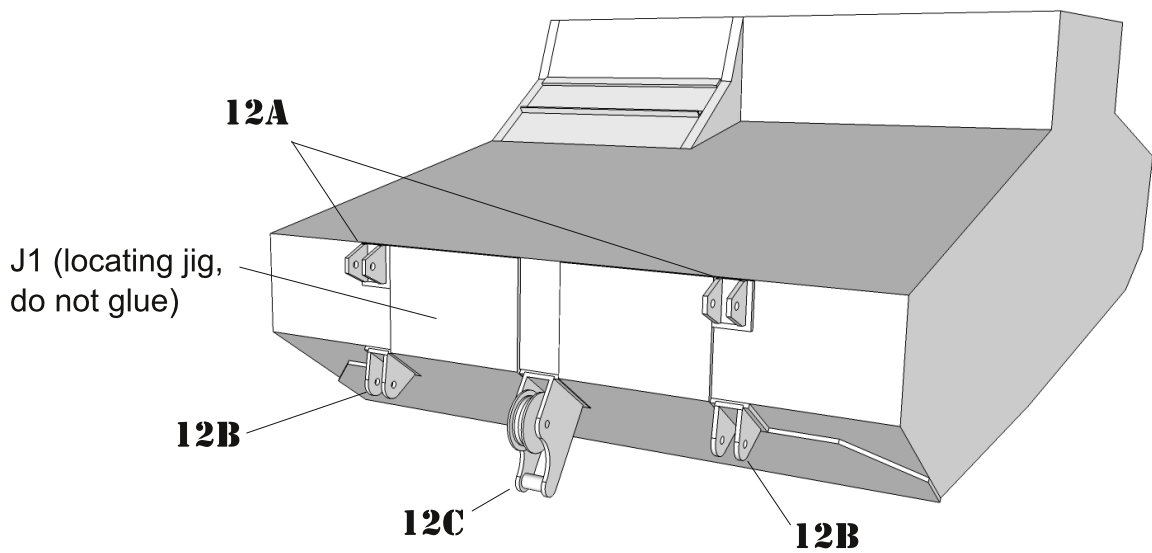
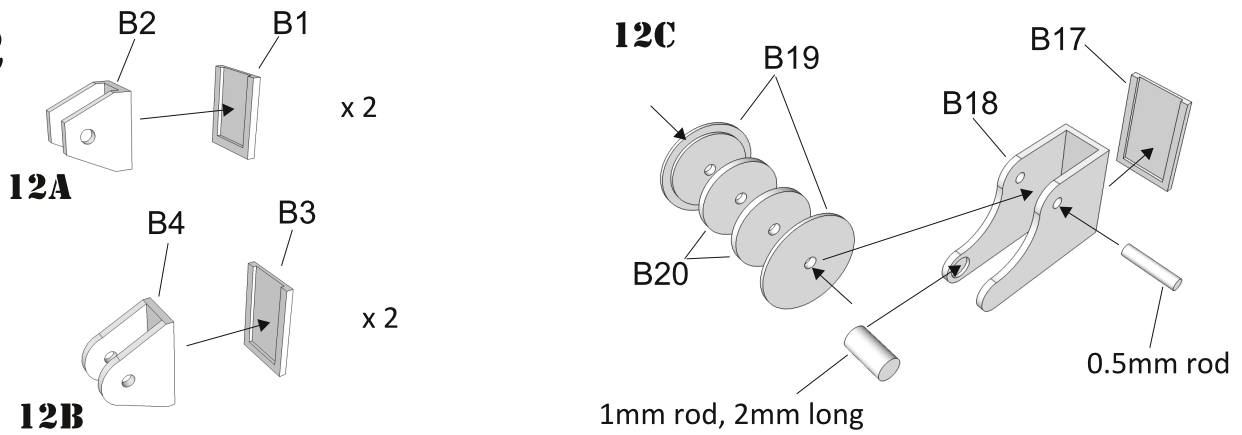

13

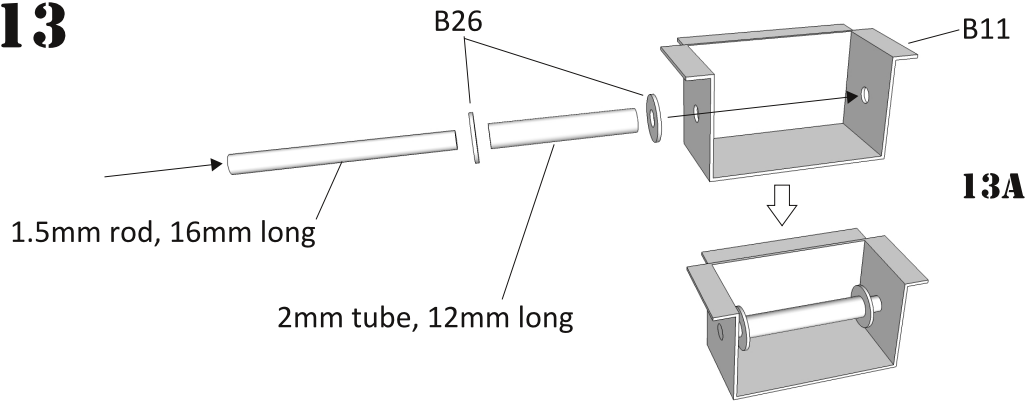

Make sure to leave enough room around the edges so that parts B33 and assembly 13A do not interfere with the edges of the hull

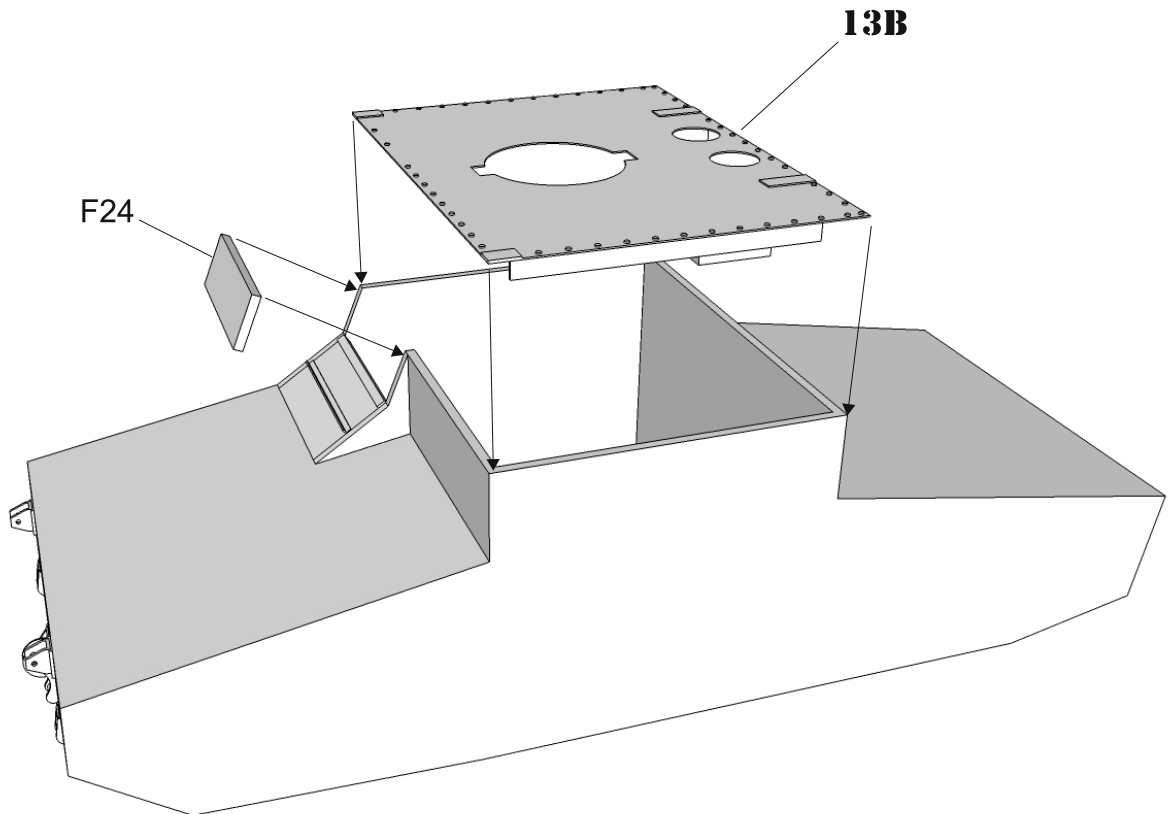
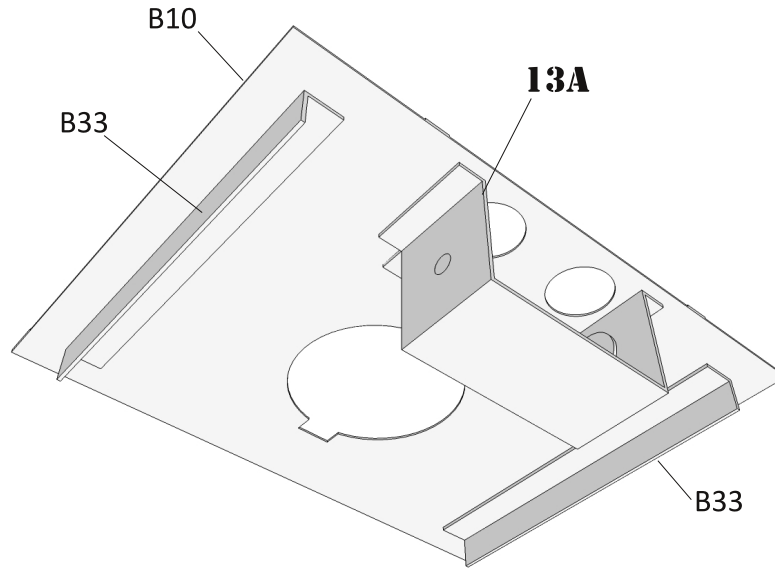

14

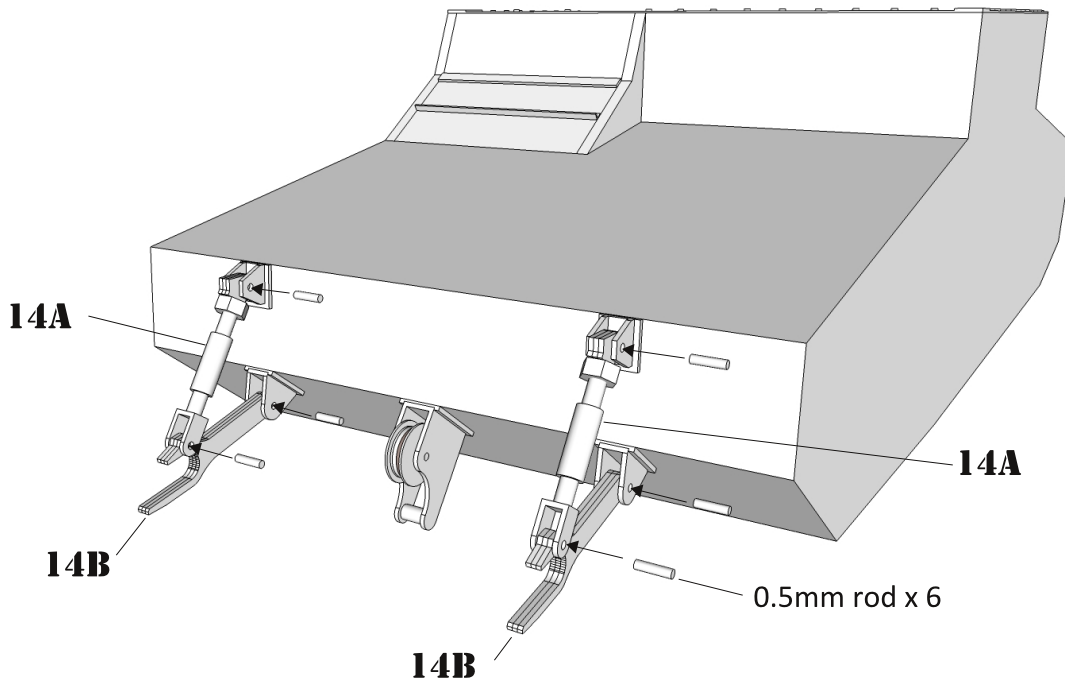
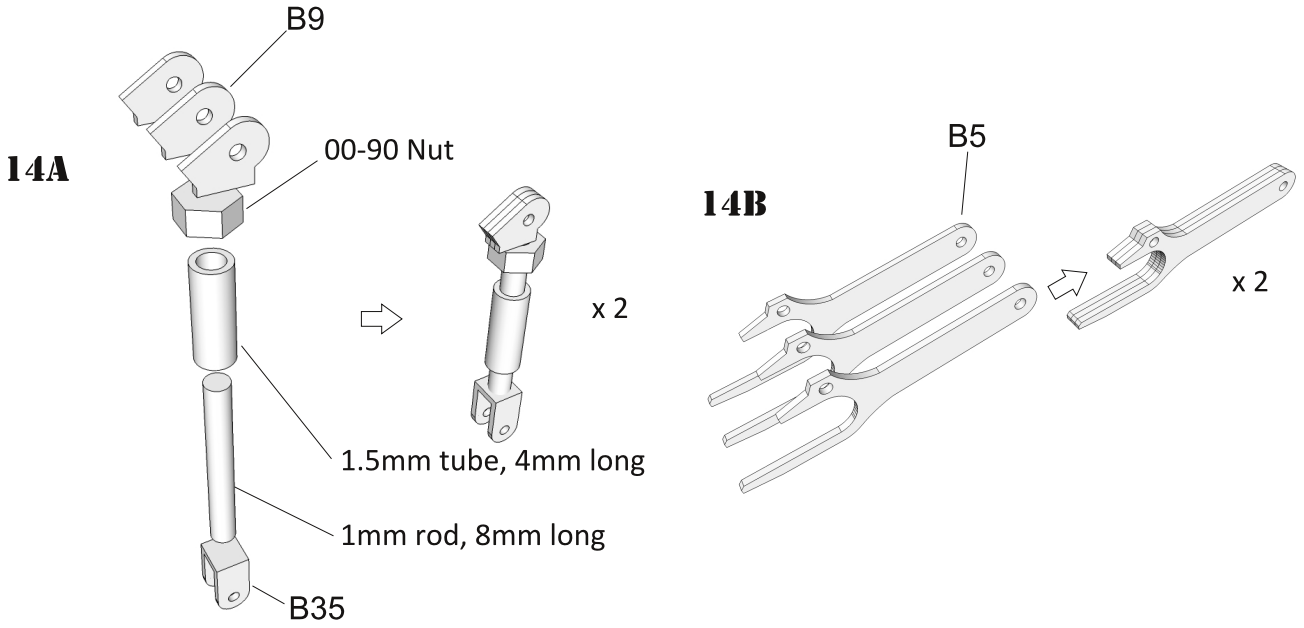

15

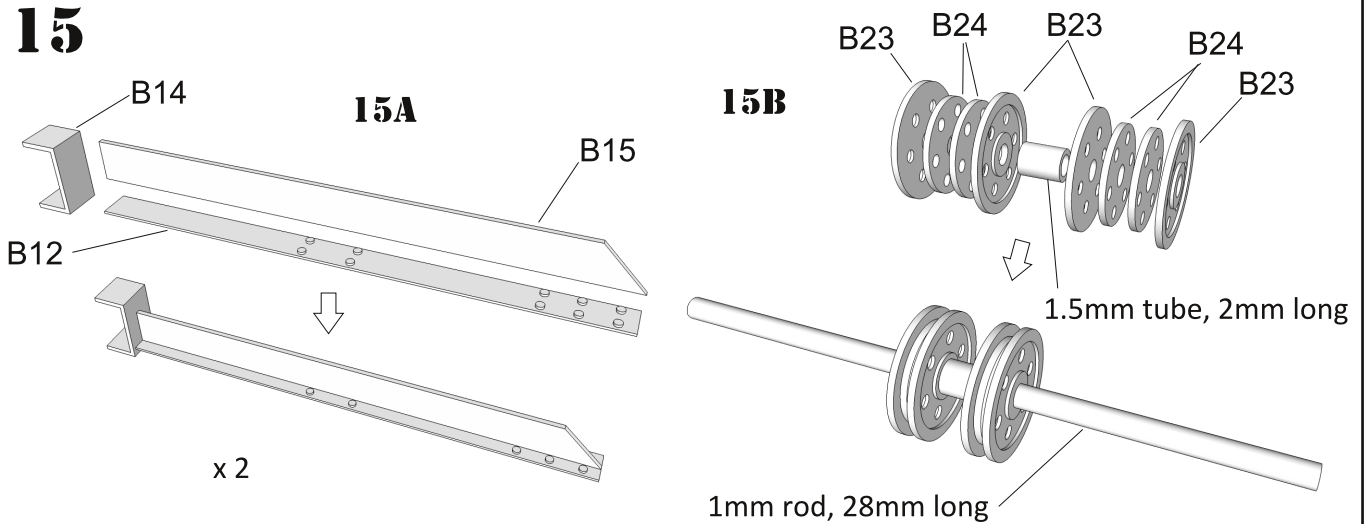

16

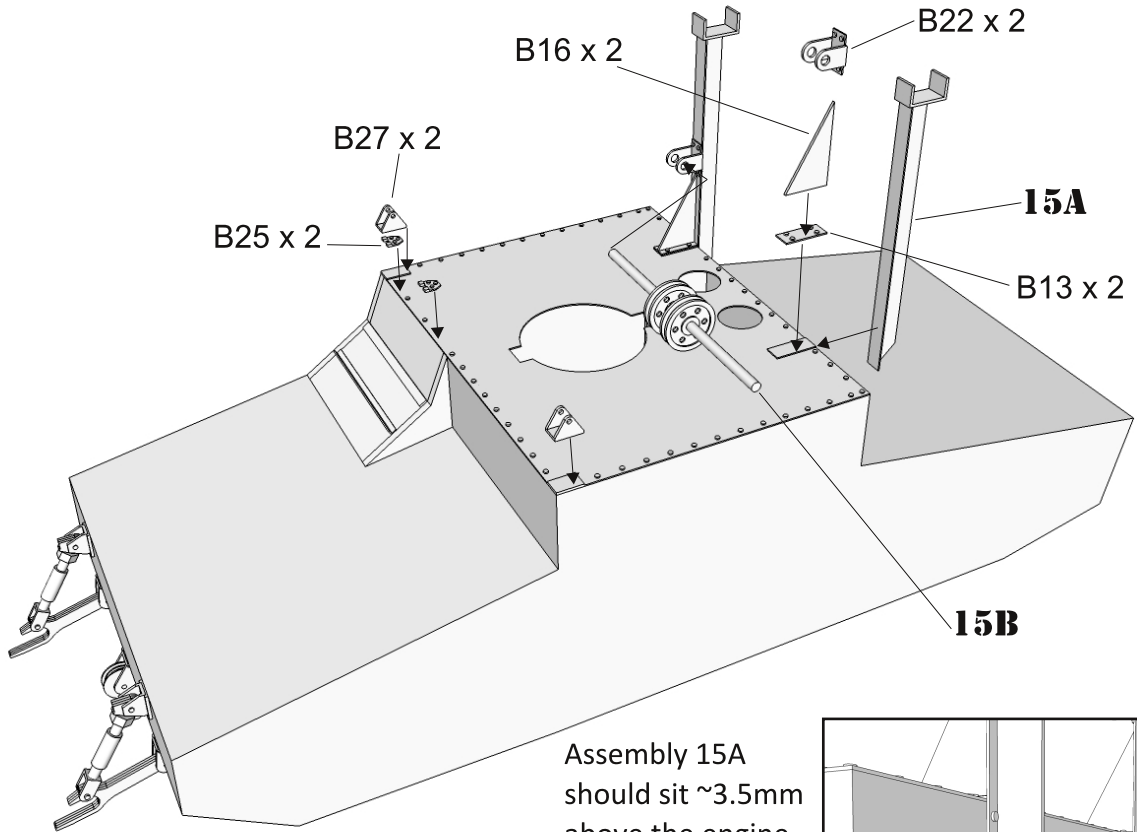

Assembly 15A should sit ~3.5mm above the engine deck

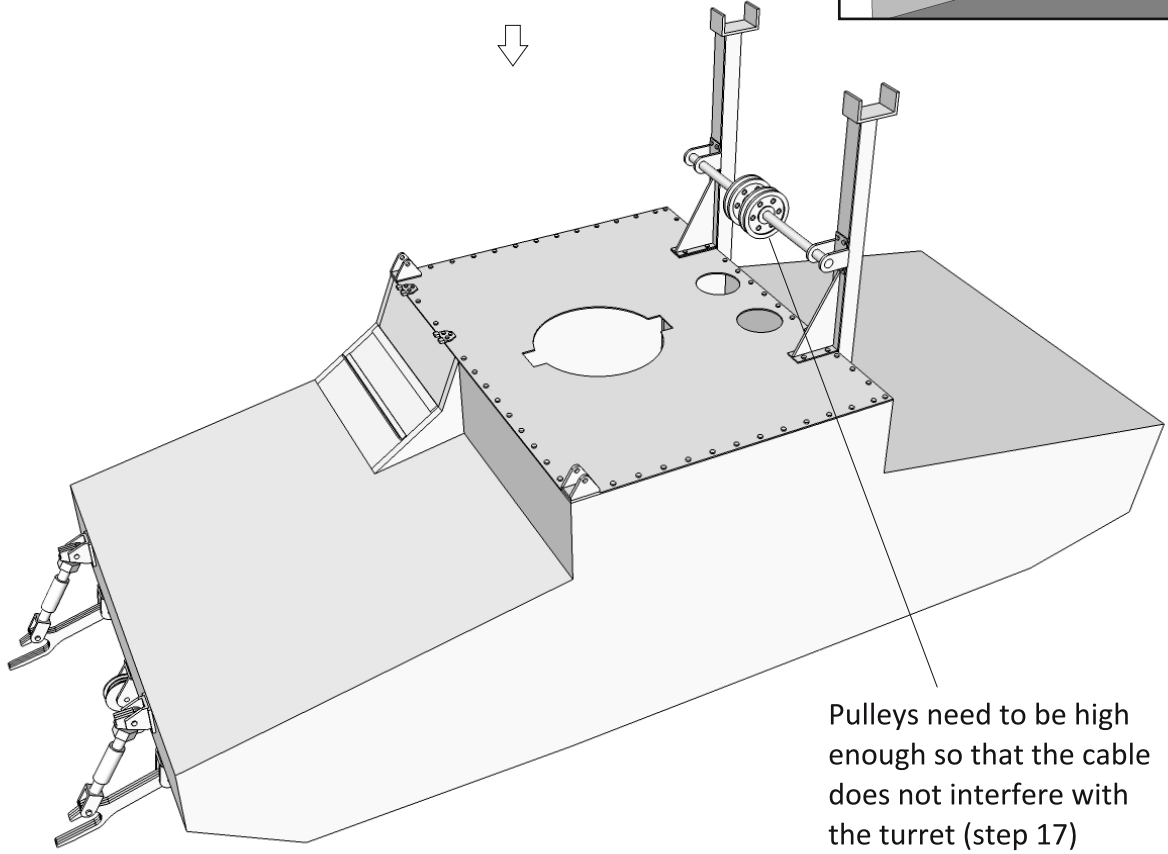
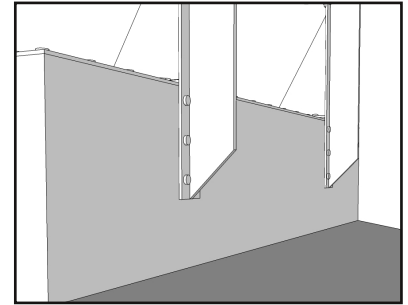

Pulleys need to be high enough so that the cable does not interfere with the turret (step 17)

17

Cut off top of turret along dotted line

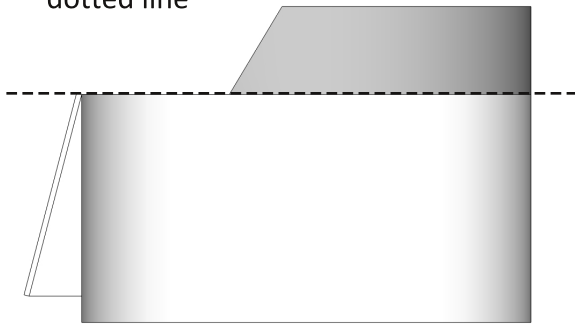

Profile View

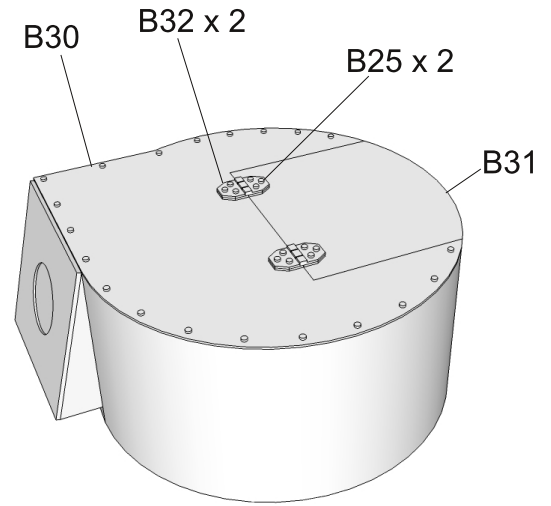

18

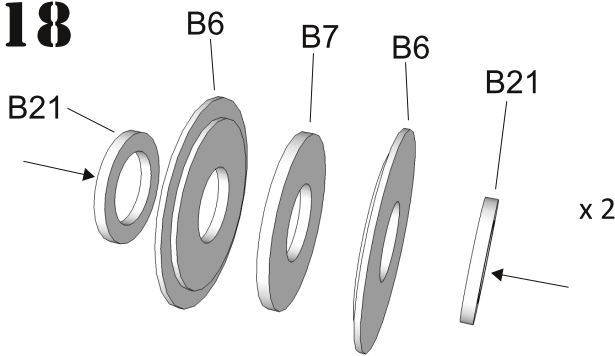

18A

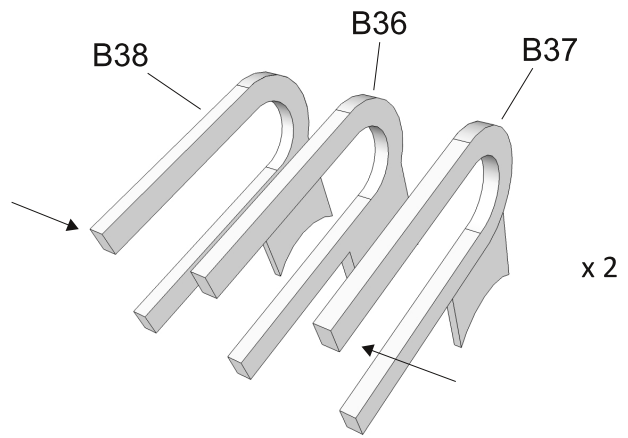

18B

19

1.5mm rod, 55mm long

3mm tube

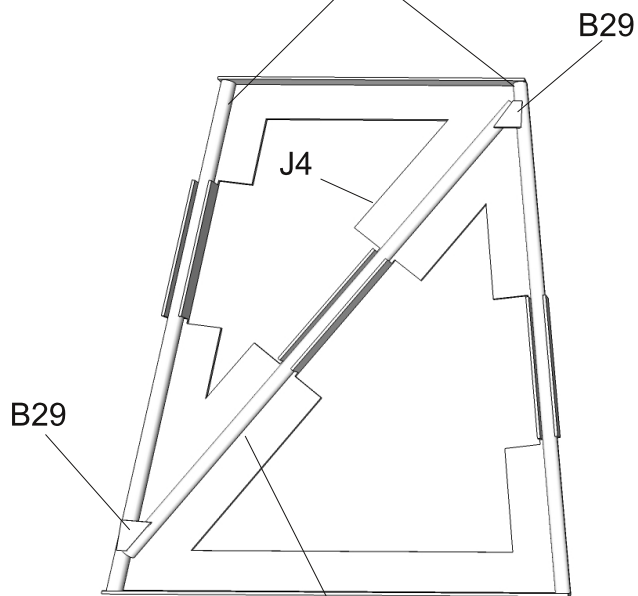

1.5mm rod, 60mm long



Remove assembly from jig, flip and repeat placement of parts B29

20

3mm tube
J5
1.5mm rod, 37mm long

Jig ensures the proper angle between the rod and the tube, as these supports widen out where they attach to the hull

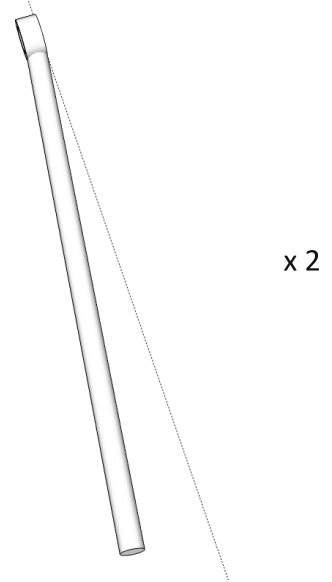

21

1.5mm rod, 37mm long
2mm tube, 33.5mm long

18B

B8

18A

19

20

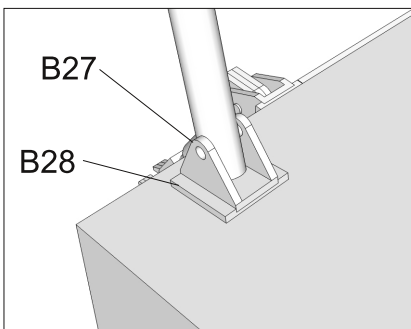

Bend the 'ears' down over the cable pulleys, roughly 45 degrees

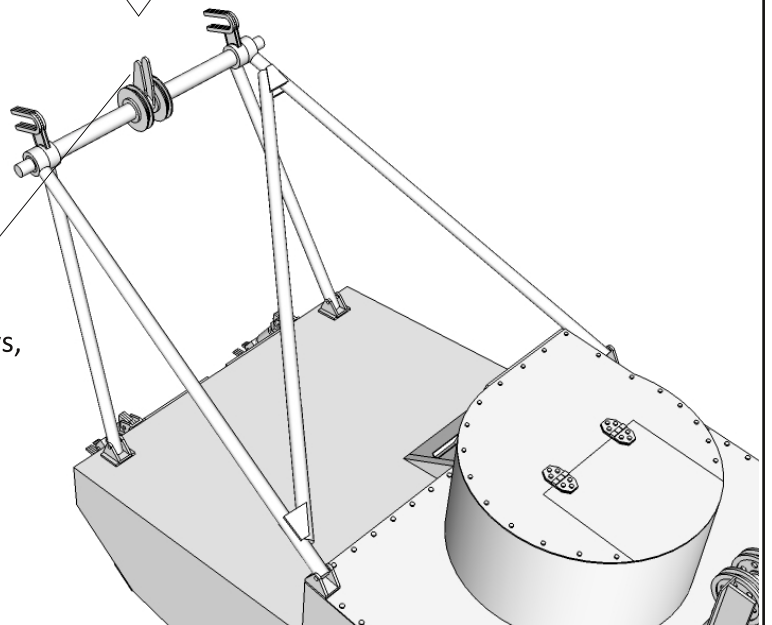

22

Slide bridge into the hooks on the front

Rest the cross member on the rear supports

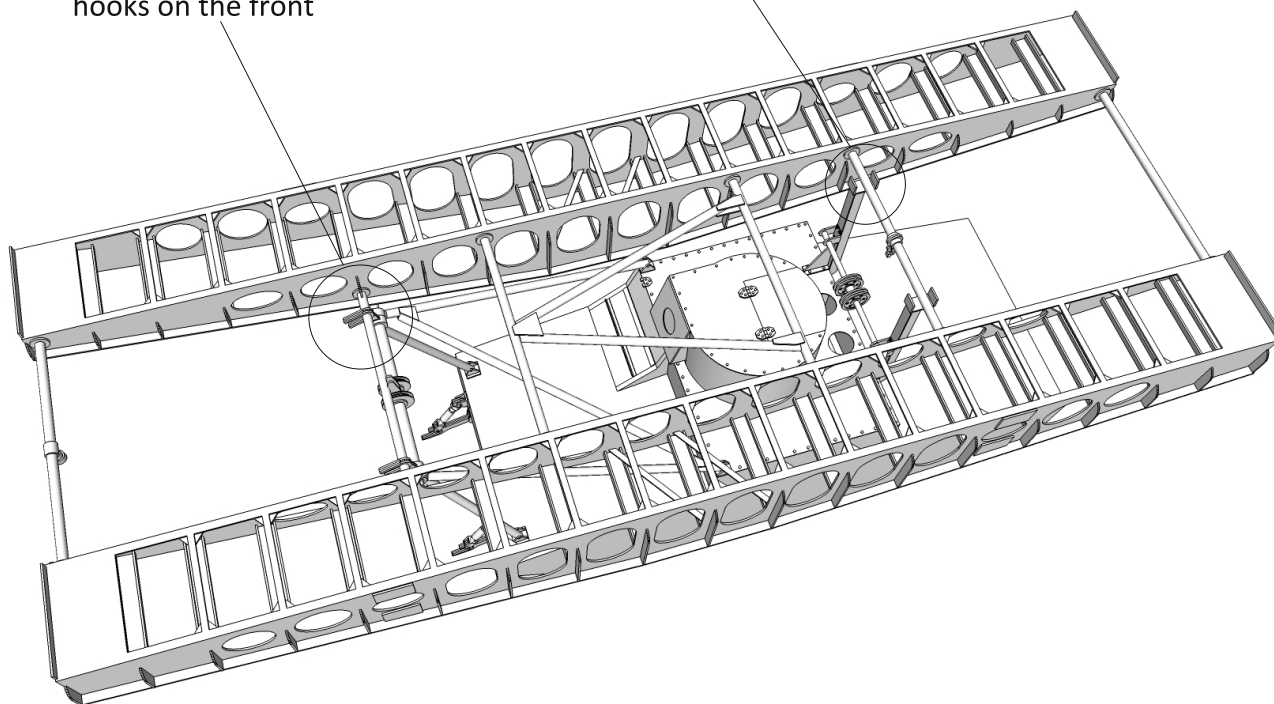

23

Rigging

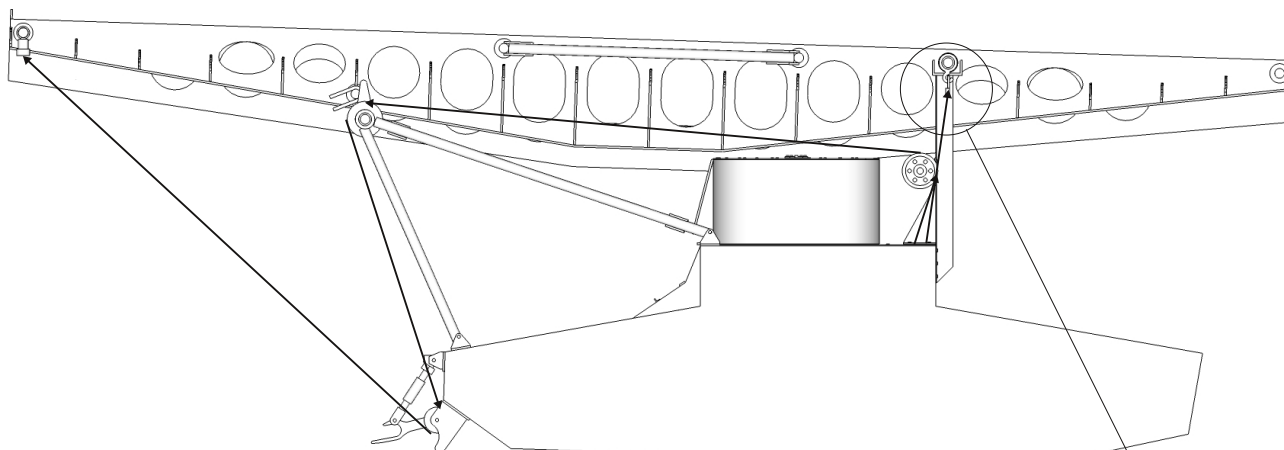

23A:

From one of the holes in the hull roof, thread the solder wire around the pulley above, over the turret and around the pulley from step 18, down around the pulley mounted to lower hull, then back up to the front cross member of the bridge from step 8.

23B:

Pinch a length of solder wire in part B34, then from the unused hole in the hull roof, thread around the unused pulley above and hook onto the assembly from step 10B.

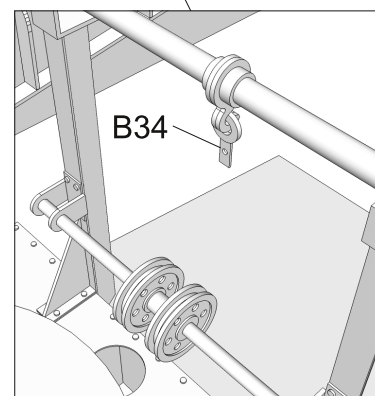

MARKING OPTIONS

- 1) Overall 4BO green
- 2) Overall 4BO green with dashed white line along top of turret
- 3) White-wash over 4BO green*

*The ST-26 saw service in the Winter War and it is likely that some received a coat of white camo, though no photographs known to me depict this.

TIPS & TRICKS

- 1) For structural connections, like the rungs for the bridging units and the cross members joining the two bridging halves together, soldering will create the strongest joint.
- 2) If soldering is not possible, Loctite, or another comparable thread locking glue will also provide a strong joint.
- 3) If modeling this kit in the midst of deploying the bridge, it may be necessary to weigh down the hull to prevent tipping.
- 4) Spare PE parts have been provided in the frets for some of the more small & fragile pieces.

Hope you enjoyed this unique kit, stay tuned for more interesting subjects.
Thank you for your support.

- James from Landships Modeling

www.LandshipsModeling.com