

®

# ITALERI



**KIT No 322 Scale 1:35 -U.S. MOTORCYCLES**

NAME  
NOME  
NAME  
NOM  
NOMBRE  
NAAM

ADDRESS  
INDIRIZZO  
ADRESSE  
DIRECCION  
ADRES

TOWN  
CITTA'  
STADT  
VILLE  
CIUDAD  
GEMEENTE

POSTAL CODE  
C.A.P.  
POSTALEITZAH  
CODE POSTALE  
CODIGO POSTAL  
POSTCODE

COUNTRY  
NAZIONE  
LAND  
PAYS  
PAIS  
LAND

DATE OF BIRTH  
DATA DI NASCITA  
GEBURTSDATUM  
DATE DE NAISSANCE  
NACIDO/A EL  
GEBORTE DATUM

E-MAIL

PLACE OF PURCHASE  
ACQUISTATO PRESSO  
ORT DES KAUFES  
LIEU D'ACHAT  
LUGAR DE COMPRA  
PLAATS VAN AANKOOP

DEFECTIVE PARTS  
PARTI DIFETTOSE  
DEFERTE TEILE  
PIECES DEFECTUEUSES  
PIEZAS DEFECTUOSAS  
DEFECTE ONDERDELEN

Retail Store  
Negozio  
Einzelhandel  
Detallant  
Detallista  
Detallhandel

Hyper Market  
Grande Magazzino  
Andere  
Grande Surface  
Gran Almacen  
Hypermarket

ITALERI S.p.A.  
Via Pradazzo, 6/B  
40012 - Calderara di Reno (BO) ITALY  
fax: 0039 51 726 459

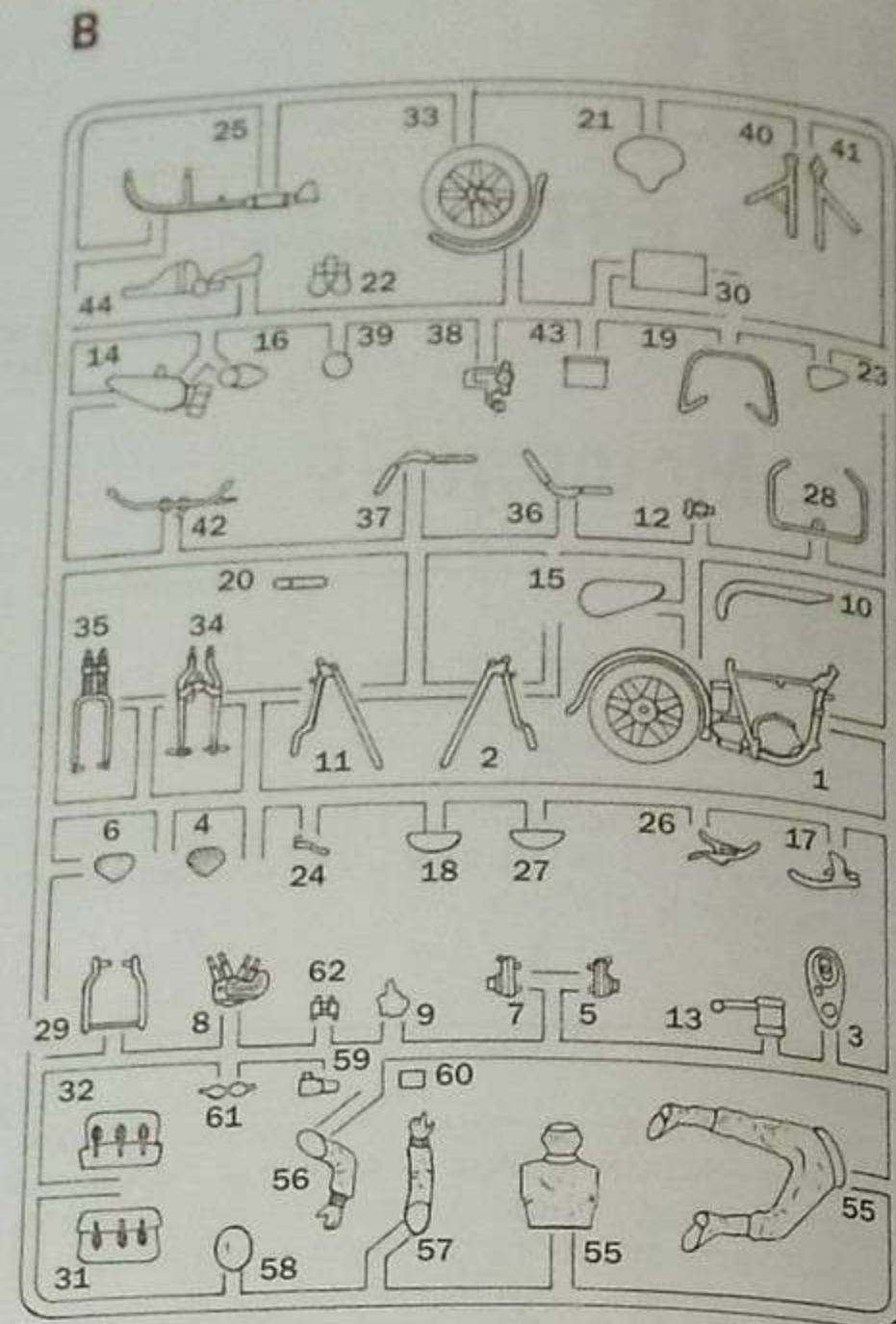
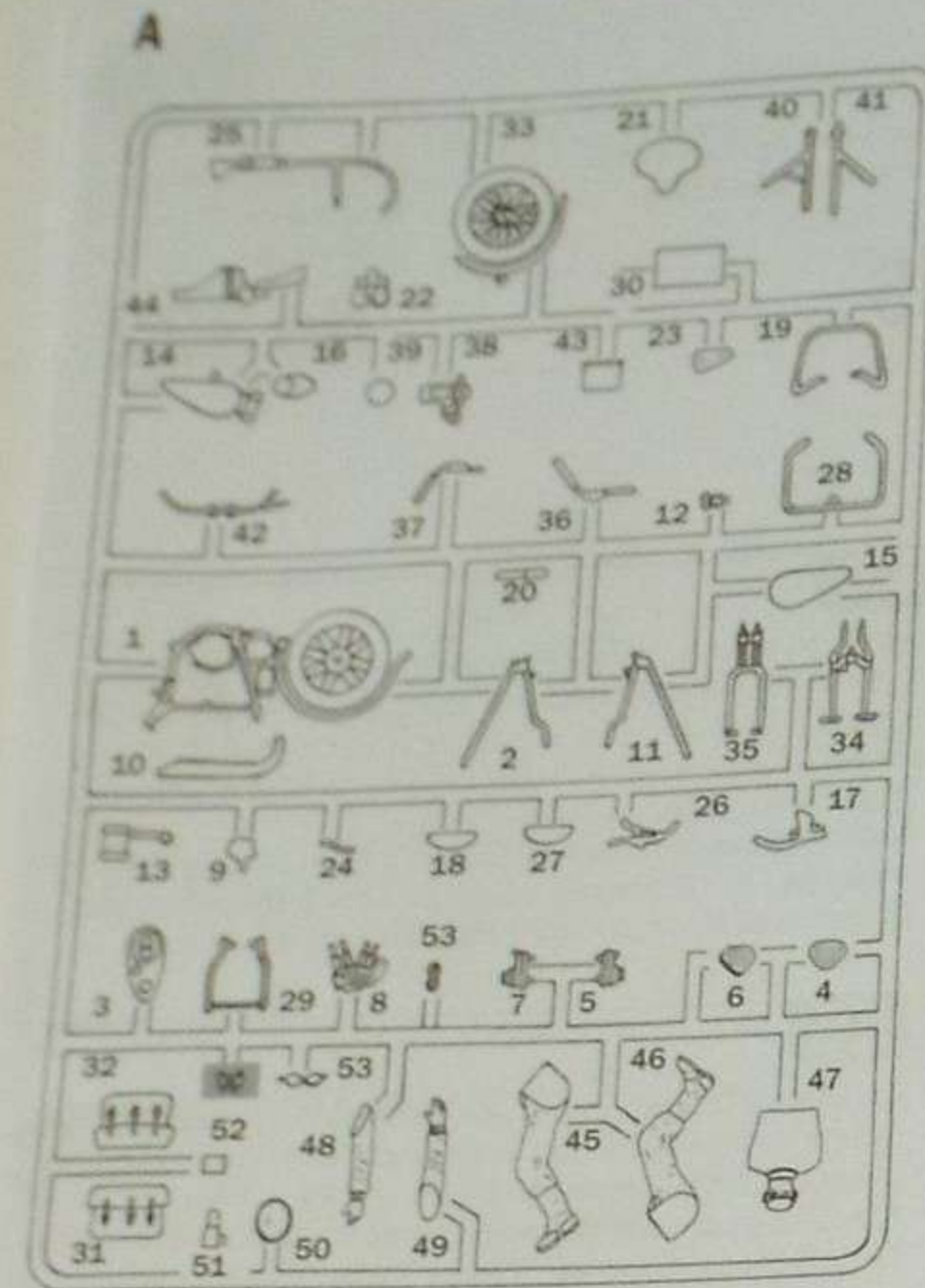

I numeri si riferiscono all'assortimento colori Italeri Acrylic Paint  
 The indicated colour number refer to the Italeri Acrylic Paint  
 Les références indiquées concernent les peintures Italeri Acrylic Paint  
 Die angegebenen Farbnummern beziehen sich auf die Italeri Acrylic Paint  
 Los números se refieren a los colores surtido Italeri Acrylic Paint  
 De nummers verwijzen naar het assortiment kleuren Italeri Acrylic Paint

Parti da non utilizzare  
 Parts not for use  
 Pièces à ne pas utiliser  
 Teile werden nicht verwenden  
 Partes a no utilizar  
 Onderdelen niet te gebruiken

<b>A</b> FLAT BLACK F.S. 37038 ITALERI ACRYLICPAINT - 4768AP	<b>B</b> FLAT GUN METAL F.S. 37200 ITALERI ACRYLICPAINT - 4681AP	<b>C</b> FLAT OLIVE DRAB F.S. 34084 ITALERI ACRYLICPAINT - 4728AP	<b>D</b> FLAT RUST F.S. 30109 ITALERI ACRYLICPAINT - 4675AP
<b>E</b> METAL GLOSS SILVER F.S. 17178 ITALERI ACRYLICPAINT - 4678AP	<b>F</b> FLAT LEATHER F.S. 30100 ITALERI ACRYLICPAINT - 4674AP	<b>G</b> GLOSS RED F.S. 11302 ITALERI ACRYLICPAINT - 4605AP	<b>H</b> FLAT WOOD F.S. 30257 ITALERI ACRYLICPAINT - 4673AP
<b>J</b> FLAT RUBBER F.S. 26081 ITALERI ACRYLICPAINT - 4861AP			

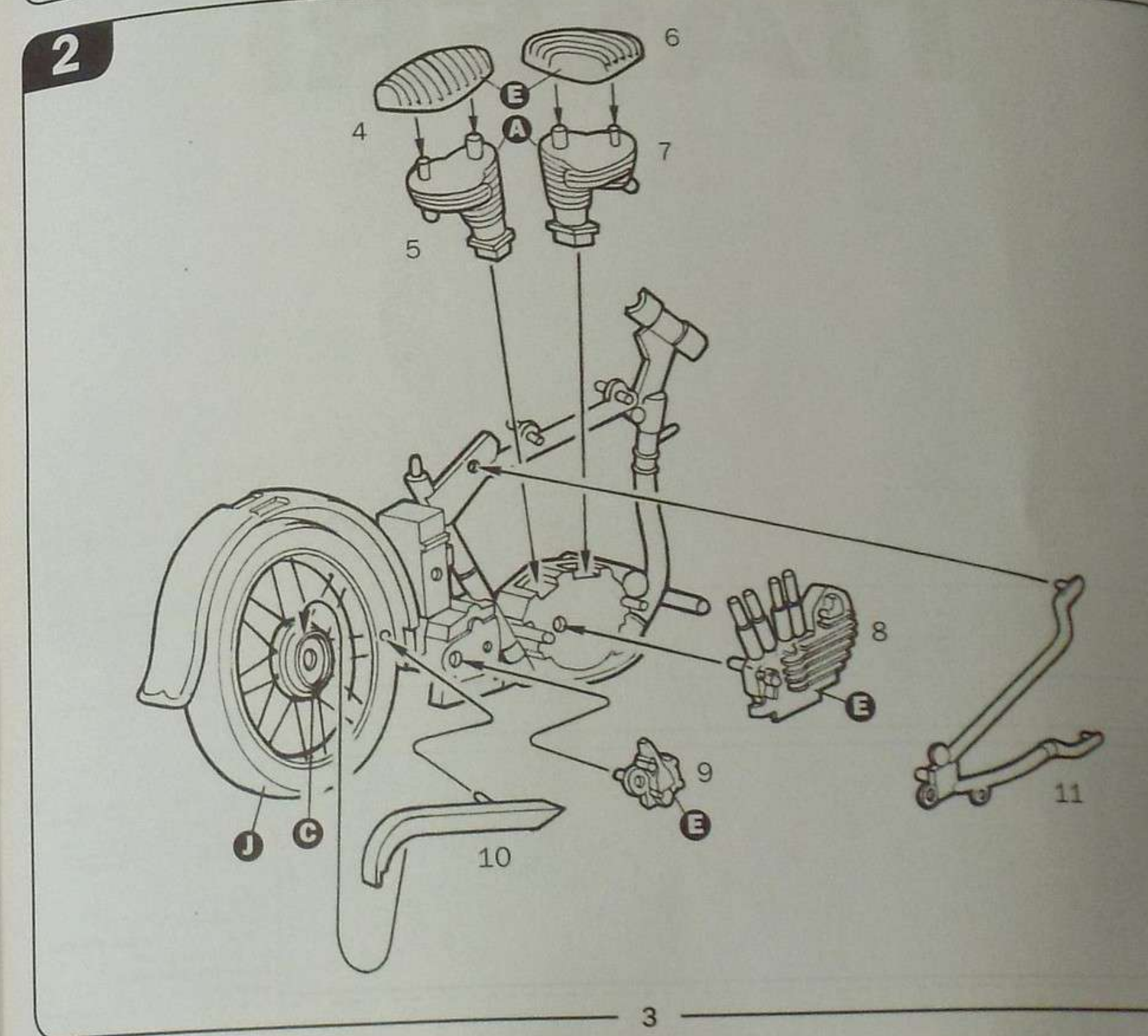
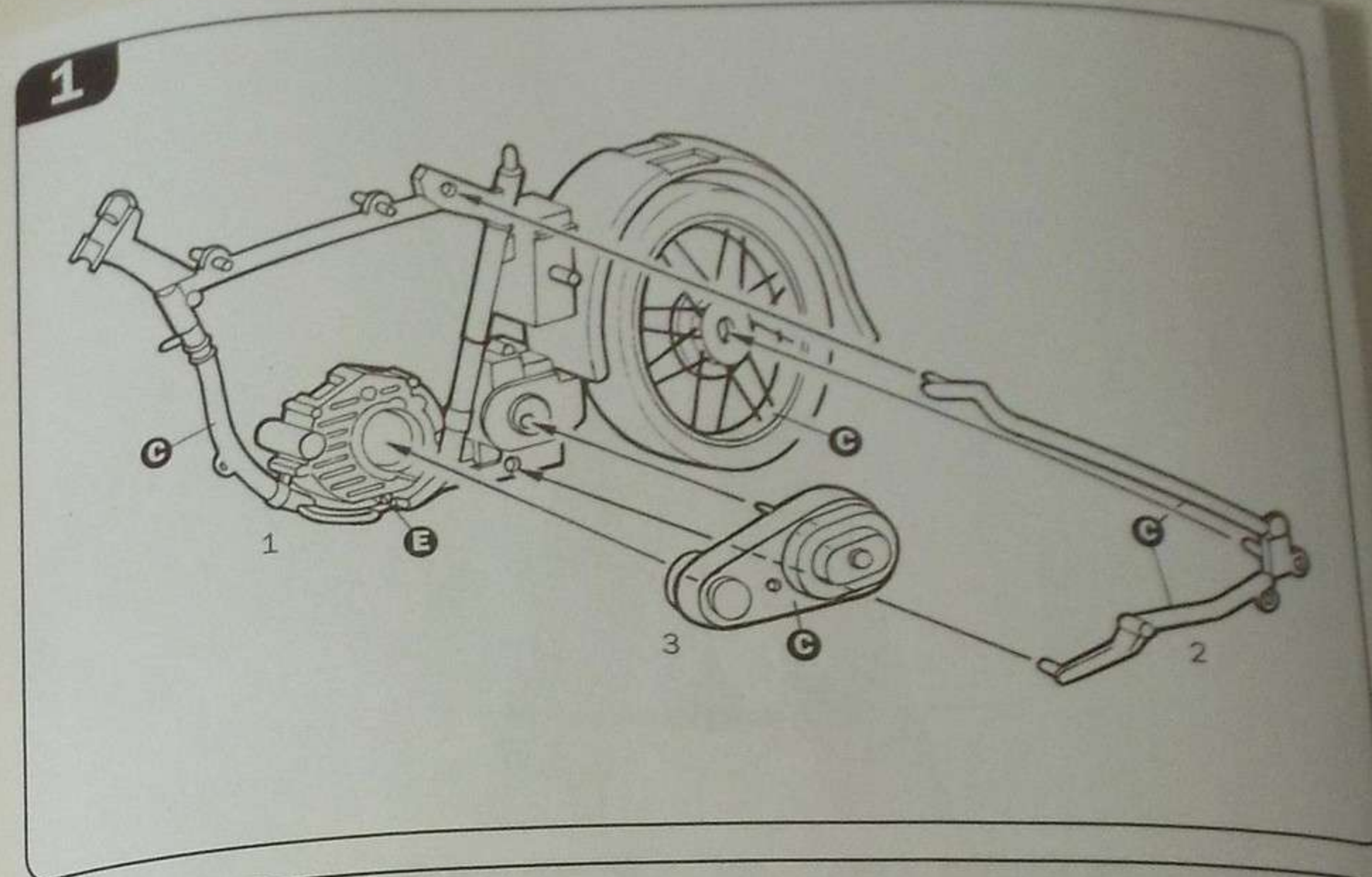

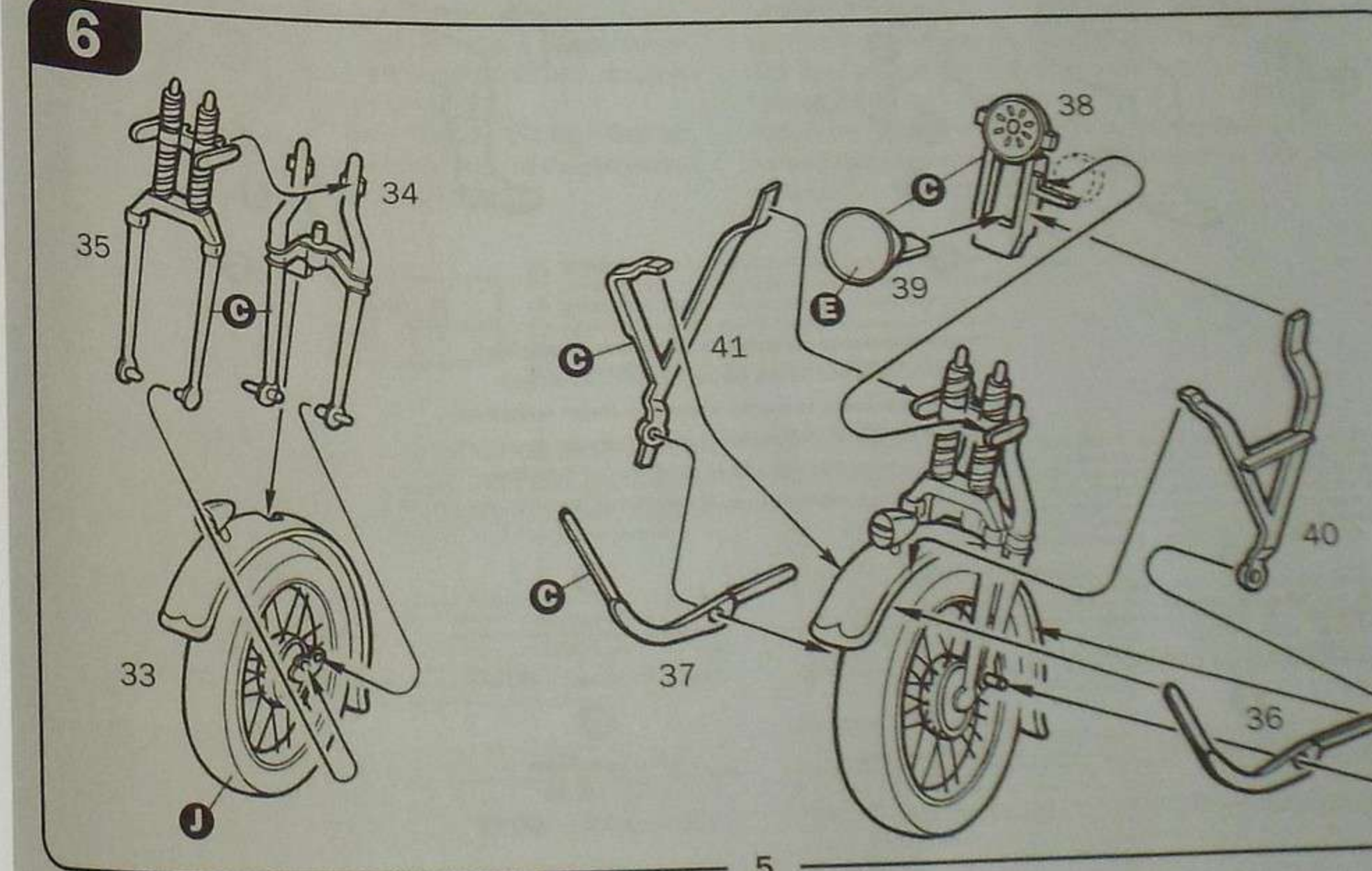
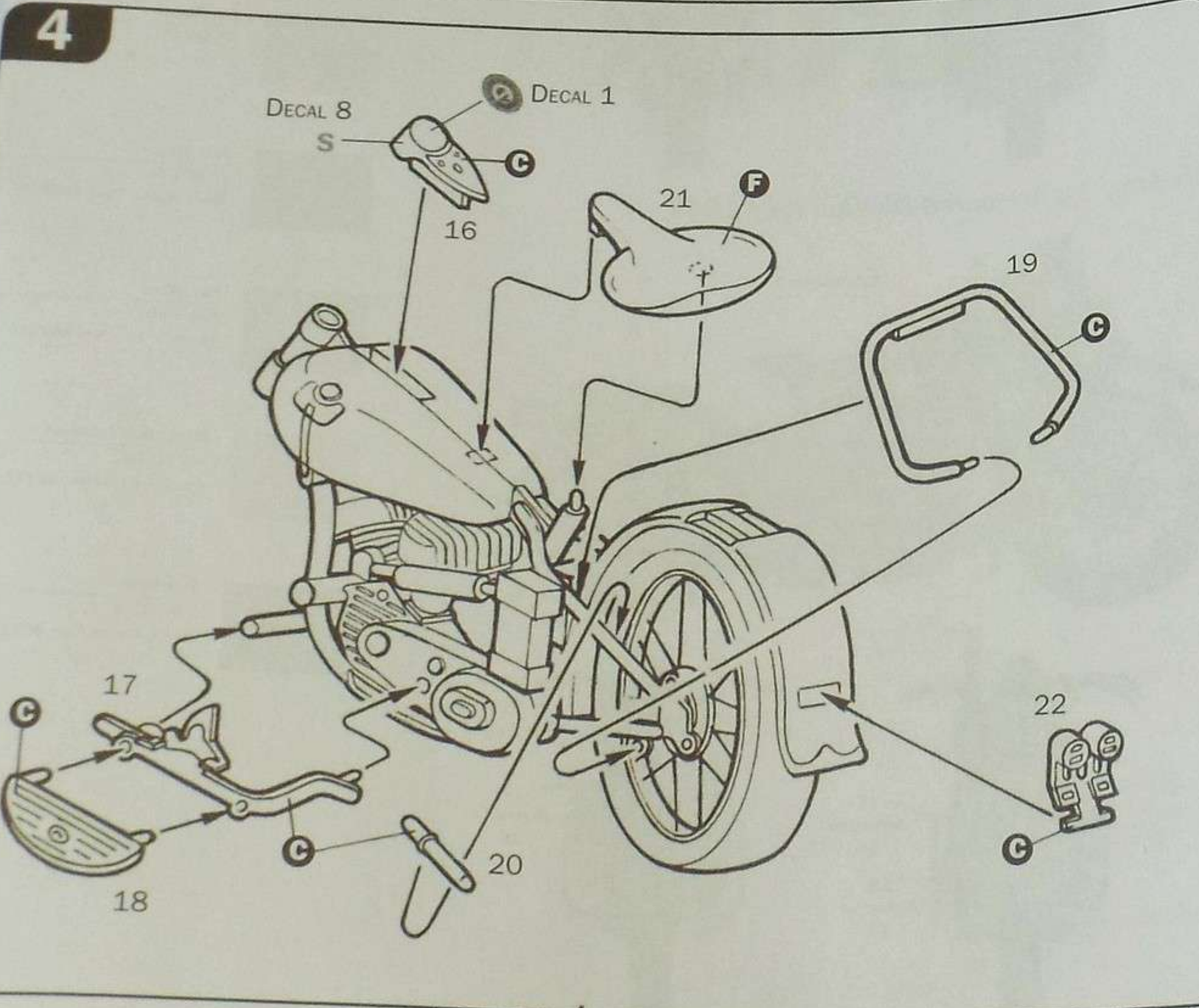
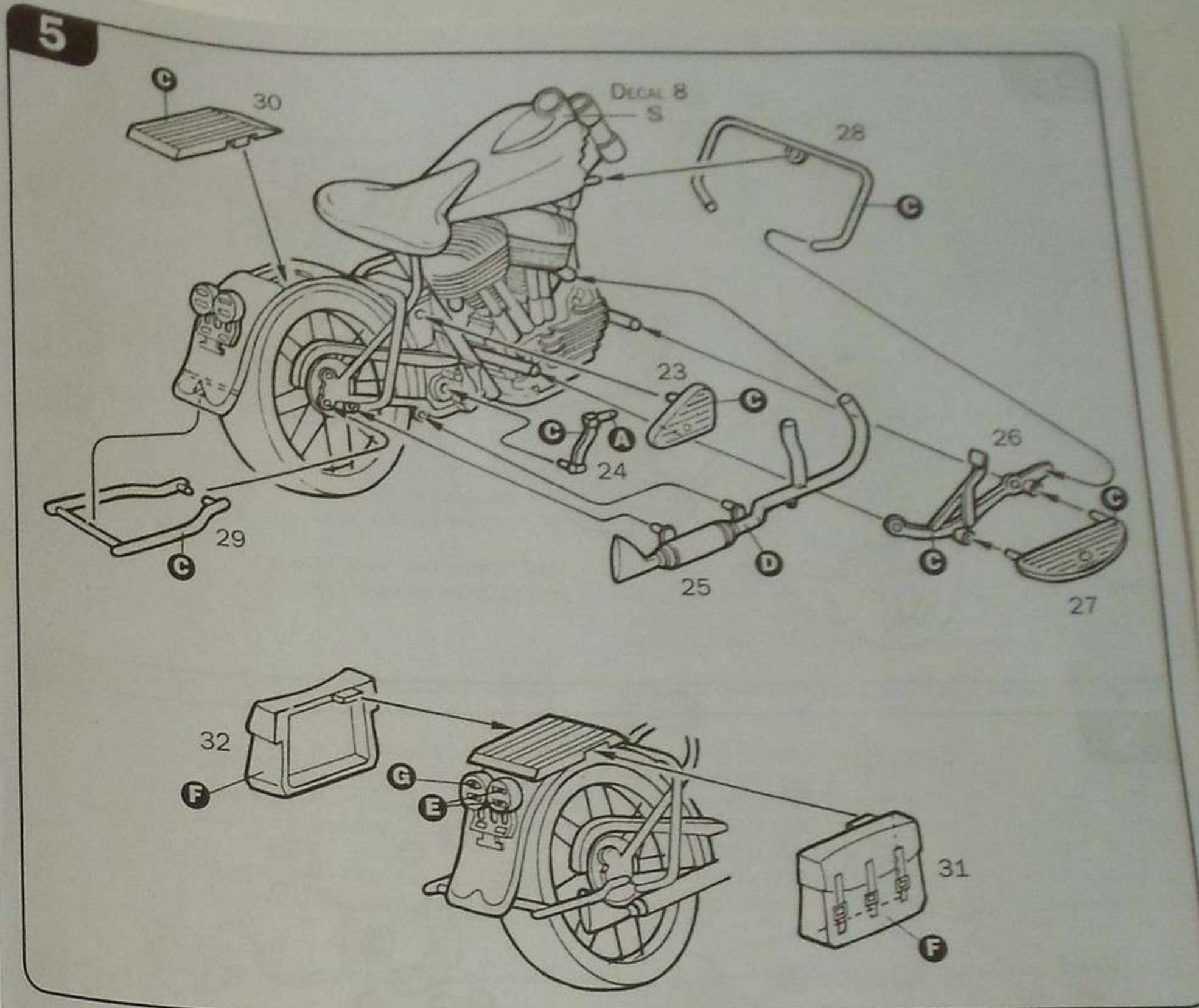
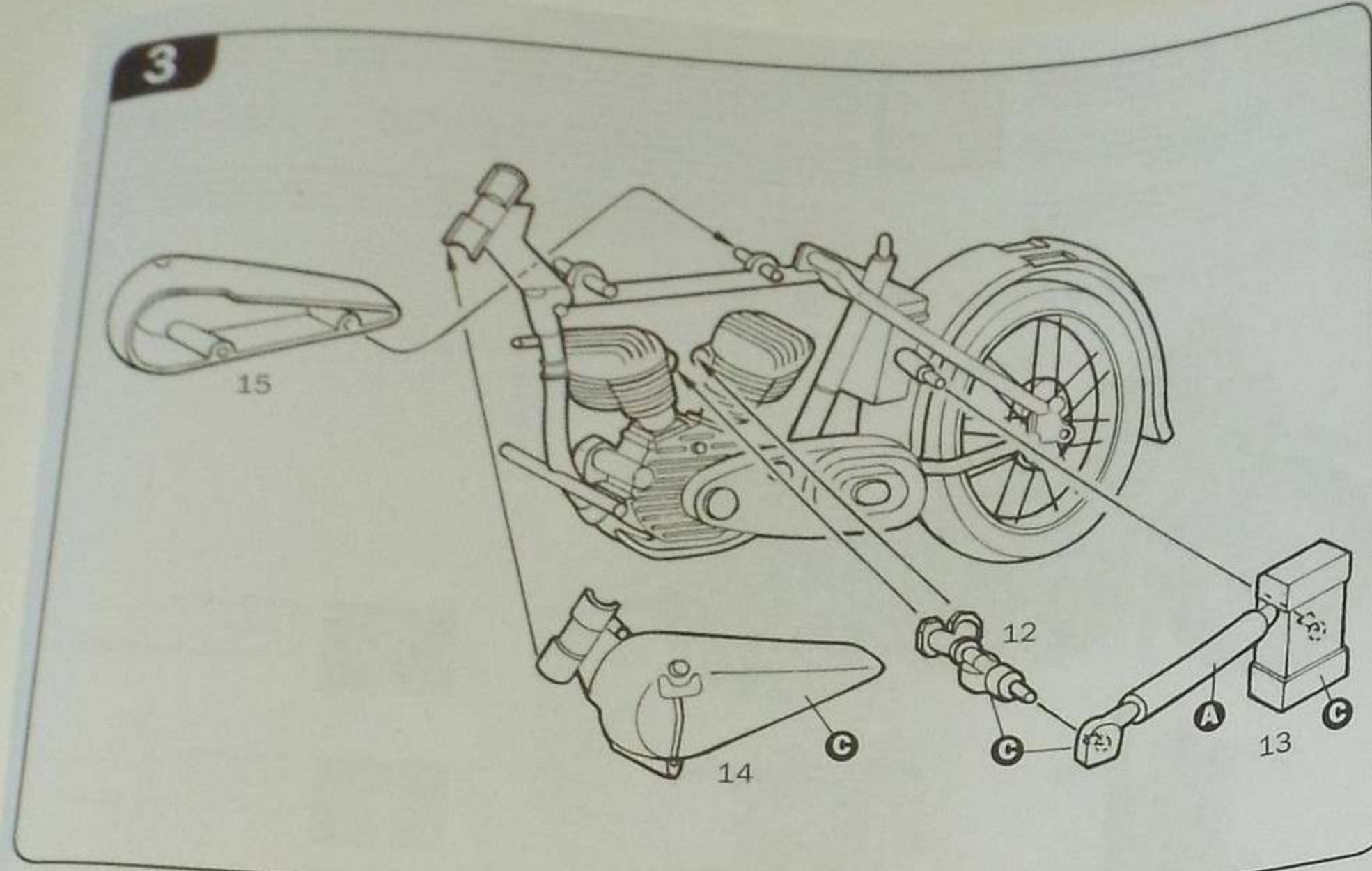

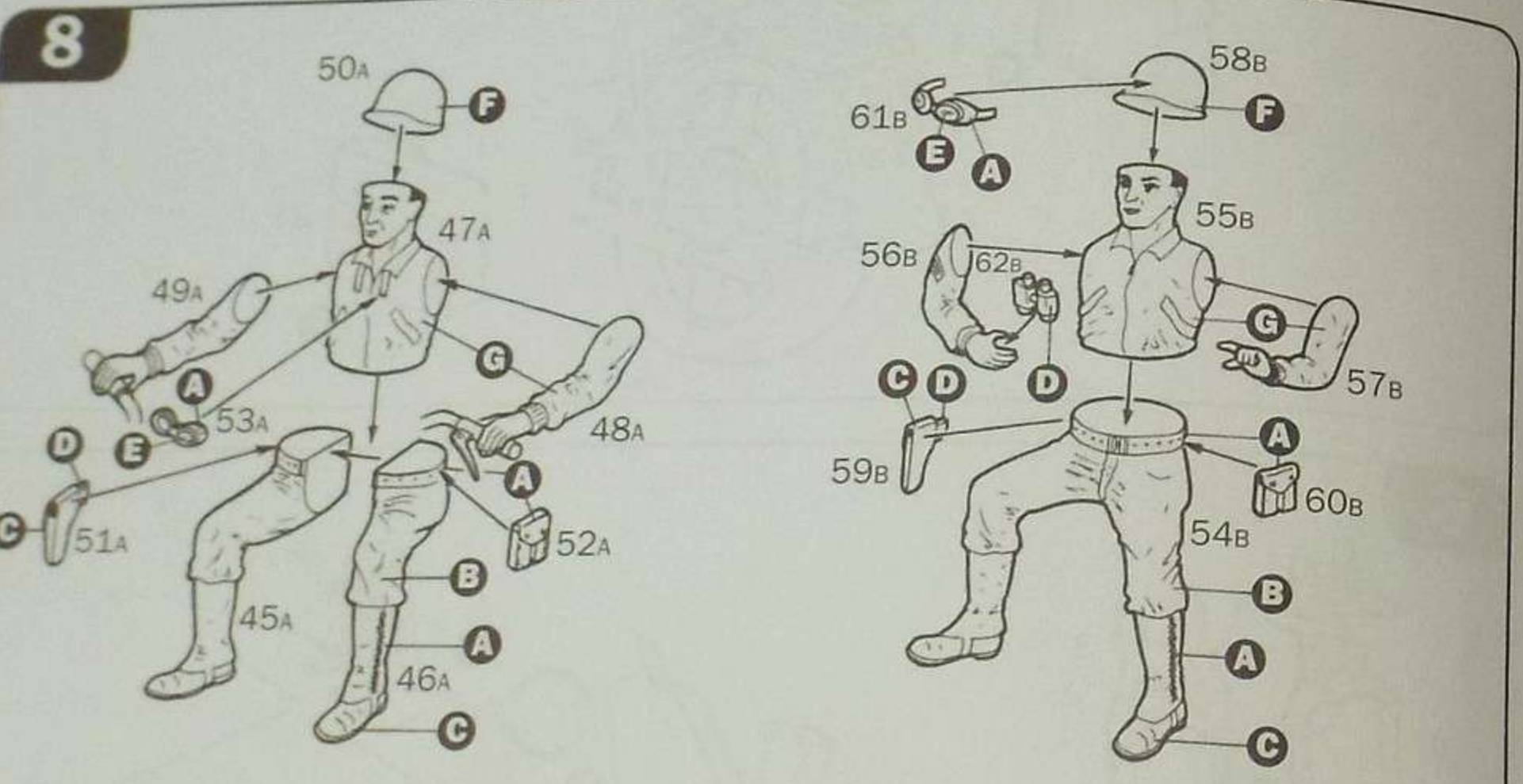
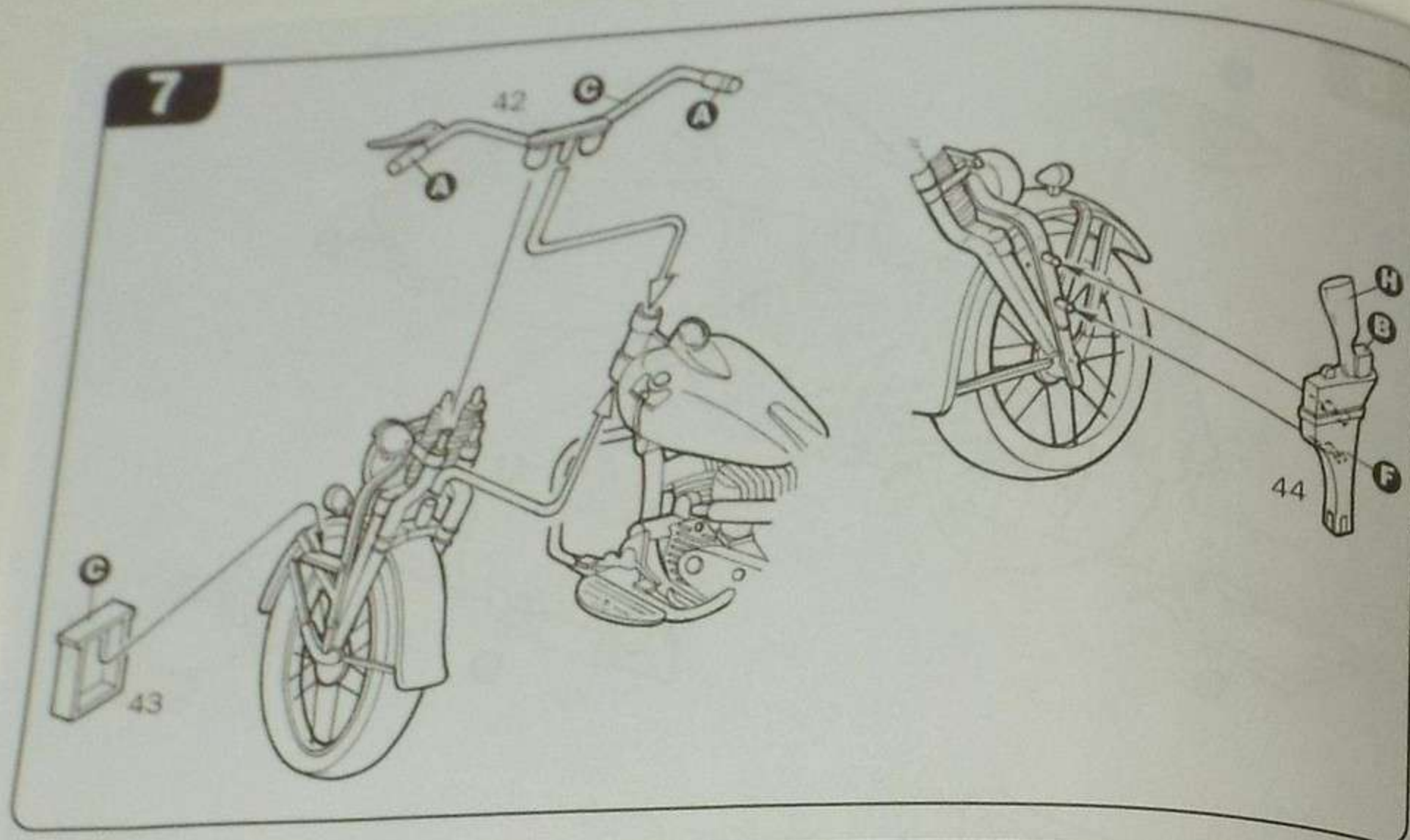

I numeri si riferiscono all'assortimento colori Italeri Acrylic Paint  
 The indicated colour number refer to the Italeri Acrylic Paint  
 Les références indiquées concernent les peintures Italeri Acrylic Paint  
 Die angegebenen farbnnummern beziehen sich auf die Italeri Acrylic Paint  
 Los números se refieren a los colores surtido Italeri Acrylic Paint  
 De nummers verwijzen naar het assortiment kleuren Italeri Acrylic Paint

- |   |  |   |   |
|---|--|---|---|
| <b>A</b>  | <b>B</b>   | <b>C</b>  | <b>D</b>  |
| FLAT FIELD DRAB<br>F.S. 30118<br>ITALERI ACRYLICPAINT - 4708AP    | FLAT DARK TAN<br>F.S. 30219<br>ITALERI ACRYLICPAINT - 4709AP   | FLAT LEATHER<br>F.S. 30100<br>ITALERI ACRYLICPAINT - 4674AP     | FLAT BLACK<br>F.S. 37038<br>ITALERI ACRYLICPAINT - 4768AP |
| <b>E</b>  | <b>F</b>   | <b>G</b>  |   |
| METAL GLOSS SILVER<br>F.S. 17178<br>ITALERI ACRYLICPAINT - 4678AP | FLAT OLIVE DRAB<br>F.S. 34084<br>ITALERI ACRYLICPAINT - 4728AP | FLAT LIGHT GREEN<br>F.S. 34230<br>ITALERI ACRYLICPAINT - 4309AP |   |

Attenzione per l'applicazione delle decalcomanie. Ritagliare le decalcomanie accuratamente dai fogli, immergerle in un bicchiere di acqua pulita per circa 10", metterle in posizione sul modello a fessura e premere sulla superficie per una migliore adesione. Completare con una spazzola soffice.

Instructions for applying the decals: Cut the required decals out of the sheets, dip them into a glass of clean water for about 10", position them on the kit, letting them settle into the position. For a better adhesion, press them by means of a clean rag.

Försiktighet vid decalering. Klipp ut den decal som skall användas och doppa den i ett glas rent vatten under en 10". Sätt decalen på plats på modellen och tryck den fast med en ren vit klud. För att den skall sitta ordentligt, tryck till med en ren klud.

Anweisungen für Abzettstellen-Anbringung: Die benötigten Abzettstellen vom Blatt ausschneiden, in ein Glas reines Wasser für etwa 10" einweichen, auf das Modell legen und dann sanft aufdrücken. Mit einer weichen Bürste die Abzettstellen mit etwas warmen Tuch abwischen.

Instruções para aplicação das decalcomanias: Cortar as decalcomanias cuidadosamente dos folhos, mergulhá-las em um recipiente de água limpa durante 10", colar as decalcomanias sobre o modelo, pressionando-as suavemente com um pano limpo. Para uma melhor aderência, esfregue-as com um pano limpo.

U.S. Army 3rd Armoured Division Normandy 1944

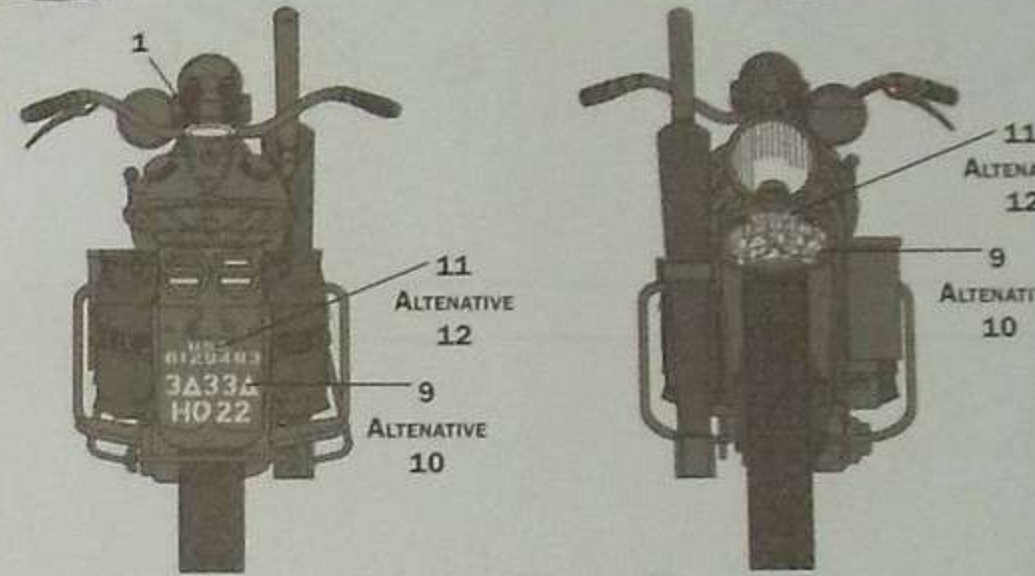
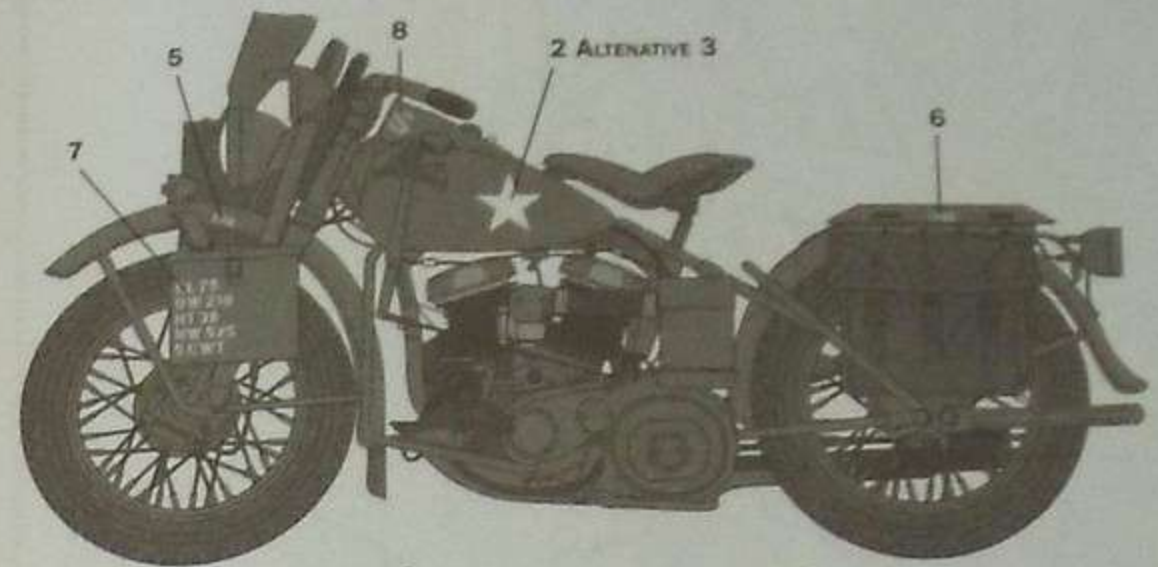

U.S. Army 1st Armoured Division Italy 1944

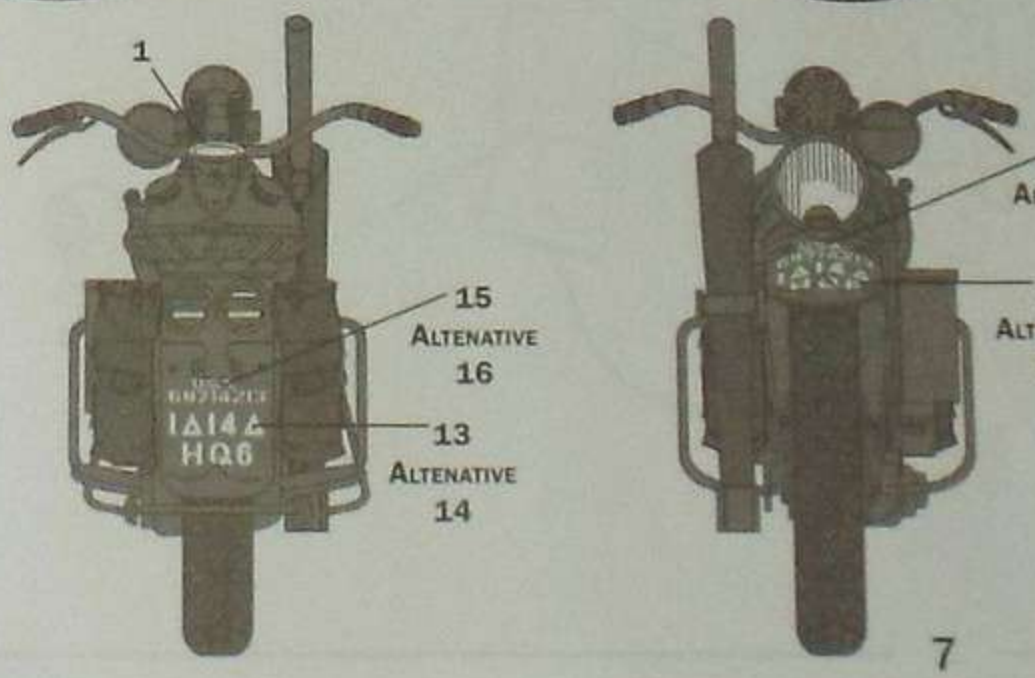
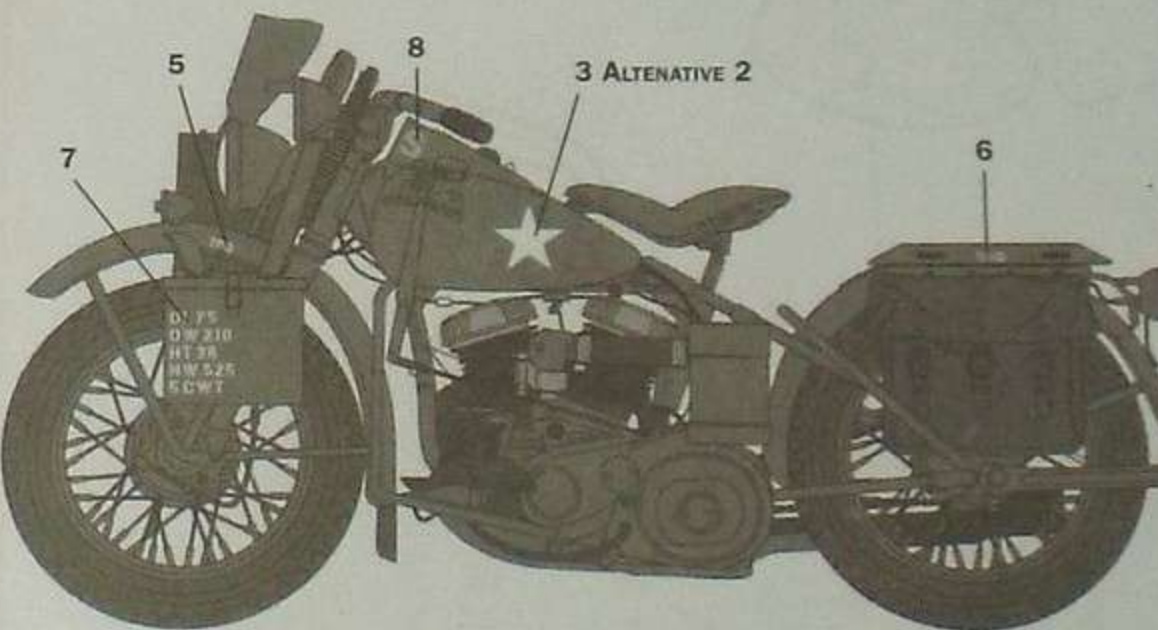

- |  |  |
|--|--|
|  | FLAT OLIVE DRAB<br>F.S. 34084<br>ITALERI ACRYLIC PAINT 4728AP      |
|  | FLAT LEATHER<br>F.S. 30100<br>ITALERI ACRYLIC PAINT 4674AP         |
|  | FLAT RUBBER<br>F.S. 26081<br>ITALERI ACRYLIC PAINT 4861AP          |
|  | FLAT BLACK<br>F.S. 37875<br>ITALERI ACRYLIC PAINT 4769AP           |
|  | FLAT WOOD<br>F.S. 30257<br>ITALERI ACRYLIC PAINT 4673AP            |
|  | METAL FLAT ALUMINIUM<br>F.S. 37178<br>ITALERI ACRYLIC PAINT 4677AP |
|  | FLAT RUST<br>F.S. 30109<br>ITALERI ACRYLIC PAINT 4675AP            |