

PO Box 40, Texaco Road, NT,  
 Hong Kong.  
 E-mail : [email@anigrand.com](mailto:email@anigrand.com)  
 Web : <http://www.anigrand.com>

**ANIGRAND**  
 CRAFTSWORK

- 1 Starboard aft fuselage x 1
- 2 Port aft fuselage x 1
- 3 Fin x 1
- 4 Port cooler intake x 1
- 5 Port tail plane x 1
- 6 Port main wing bottom x 1
- 7 Port main wing top x 1
- 8 Model "A" port wing tip x 1
- 9 Model "C" port heater x 1
- 10 Oval crews window (vacform part) x 6
- 11 Upper sight window (vacform part) x 1
- 12 Canopy (vacform part) x 1
- 13 Flight engineer instrument panel x 1
- 14 Crews seat x 4
- 15 Control lever x 2
- 16 Center console x 1
- 17 Port fore fuselage x 1
- 18 Port radar halve x 1
- 19 Starboard radar halve x 1
- 20 Starboard fore fuselage x 1
- 21 Nose gear strut x 1
- 22 Nose landing gear x 1
- 23 Nose wheel x 2
- 24 Nose gear door x 1
- 25 Propeller spinner x 4
- 26 Starboard propeller blade x 6
- 27 Port propeller blade x 6
- 28 Engine nacelle top x 4
- 29 Engine insert x 4
- 30 Engine nacelle bottom x 4
- 31 Main gear door x 2
- 32 Main gear strut x 2
- 33 Main landing gear x 2
- 34 Main wheel x 4
- 35 Flap hinge fairing #1 x 2
- 36 Flap hinge fairing #2 x 2
- 37 Flap hinge fairing #3 x 2
- 38 Flap hinge fairing #4 x 2
- 39 Flap hinge fairing #5 x 2
- 40 Flap hinge fairing #6 x 2
- 41 Flap hinge fairing #7 x 2
- 42 Model "A" starboard wing tip x 1
- 43 Model "C" starboard heater x 1
- 44 Starboard main wing bottom x 1
- 45 Starboard main wing top x 1
- 46 Side window (vacform part) x 46
- 47 Reinforce stand x 1
- 48 Starboard tail plane x 1

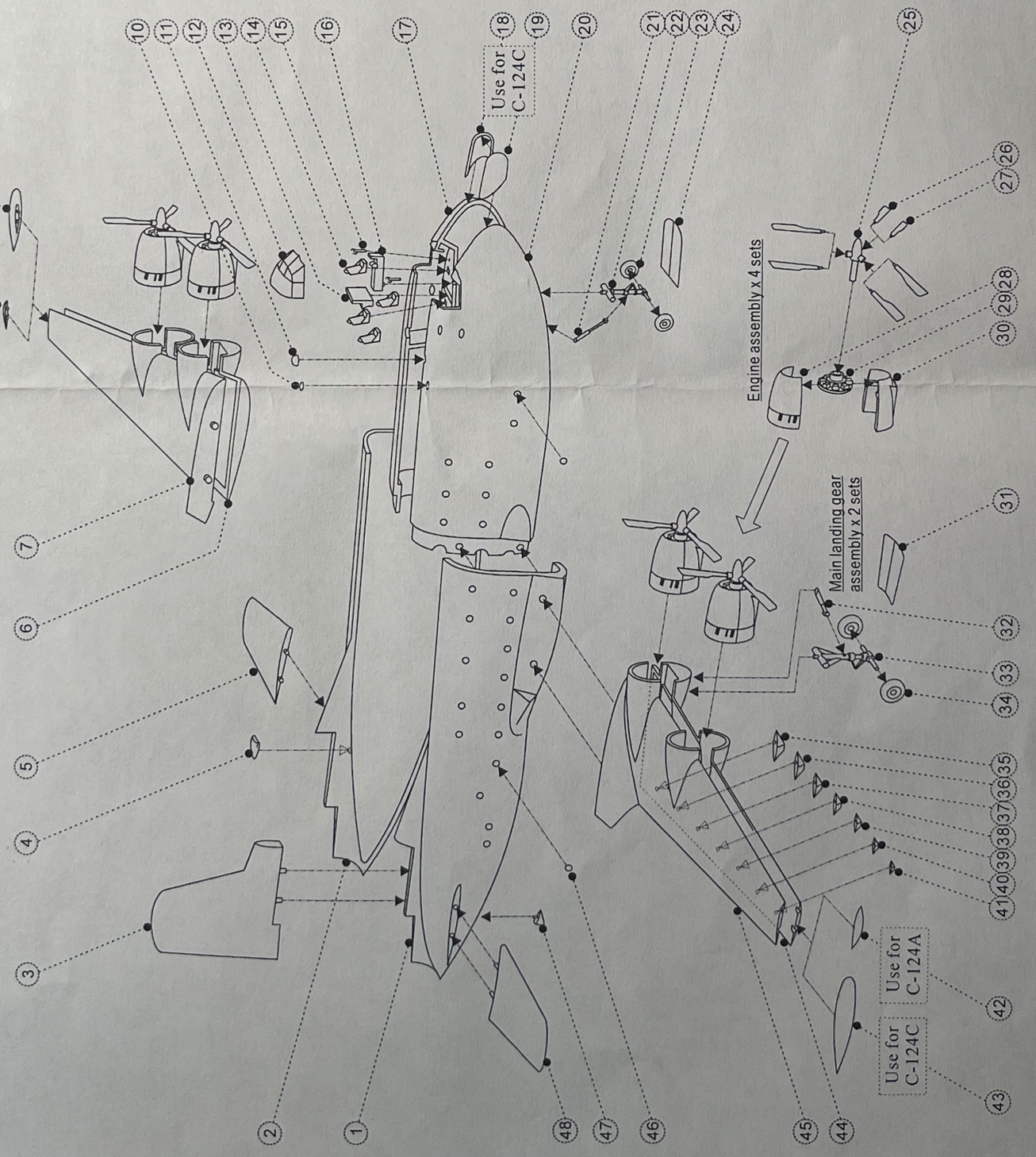



# Douglas C-124 GlobeMaster II

1/72 scale resin model kit

#AA-2067

## Specifications:

Wingspan - 174ft.1in.

Length - 130ft.5in.

Height - 48ft.4in.

Powerplants - 2x Pratt & Whitney R-4360-63A radials engine

Crew - 7

Max speed - 320 mph

Armament - 200 troops, or 123 litters, or 45 patients with 15 attendants, or 74,000 pounds cargo

After the end of the second World War, the USAAF found the C-74 Globemaster was a very capable and useful aircraft, and began to consider acquiring an improved version proposed by Douglas. It used the same wing, tail and engines from the C-74, but featured a new and enlarged fuselage, as well as clamshell doors in the nose. The result was the C-124 Globemaster II. The YC-124 prototype made its first flight in 1949. The first operational C-124 was delivered in 1950. It provided valuable service in the Korean war, but was deemed too slow in the Vietnam era, so it was earned nickname "Old Shakey". A total of 204 C-124A, and 243 C-124C were built, a turboprop-powered KC-124B tanker variant was considered. In 1970, most the C-124s were transferred to the Air Force Reserve and the Air National Guard. The C-124 was finally replaced by the C-5 Galaxy in 1974.

## Painting & Decals

Drawing scale: 1/288

