

Instructions PN116/PN117

N Scale Corner Shop & Pub



READ THROUGH ALL THE INSTRUCTIONS BEFORE YOU START.

This is a complex kit that requires attention to detail, so proceed with care!

To construct this kit you will need a few basic tools:

1. A modellers knife.
2. A pair of sharp scissors.
3. A steel ruler.
4. Glue - See glues below.
5. Ultra Fine Tip Glue Applicator, see below.
6. A cutting surface - a sheet of card or cutting mat will do.
7. Fine point tweezers.
8. Watercolour paints and fine brush.

GLUES

SPEEDBOND by Deluxe Materials is our glue of choice for this kit see www.deluxematerials.com



Also UHU Solvent Free All Purpose Adhesive Both work in our Ultra Fine Tip Applicators.

METCALFE

Ultra Fine Tip Glue Applicators.

An absolute 'must' when building this kit. Perfect amounts of glue can be applied to very precise areas without any mess.



Speed Bond in an applicator was used to build this kit.

A METCALFE product supplied in packs of 3 Product code MT907

Glue not included



Contents of this kit



2 x Sheet A.

Each sheet contains all the printed components to build one shop/pub.



1 x Sheet B.

Printed parts for the pub frontage and a variety of shop signs.

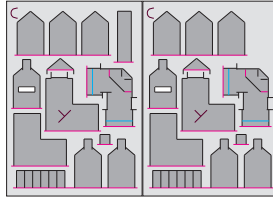

1 x Sheet C.

Plain grey thick card inner strengthening components. Each half of the sheet contains the parts for one complete building. Key to components page 2.

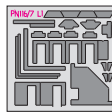

1 x Laser Cut Sheet L1.

Fine laser cut door frames, door step's the pub base card and various bracing strips for signs etc.

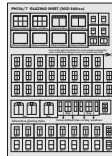

1 x Glazing Sheet.

This clear plastic sheet is printed with two complete sets of windows plus a few extra alternative window styles.

1 x Instruction Booklet.

This one!

GETTING STARTED

1 Extracting Components from the Base Sheet

To stop the components from falling off the printed sheet, they are held secure with score lines (marked with blue arrows) that cut about 75% of the way through the card. To release them run the point of your knife along these scores and they will come along seamlessly away.

Build the shops one at a time.

Only extract the components from 1 x Sheet A. and one half of Grey Sheet C.

Components on **Sheet B** and the Laser cut sheet **L1**. can be left on the sheet until needed.

Grey Card Sheet C

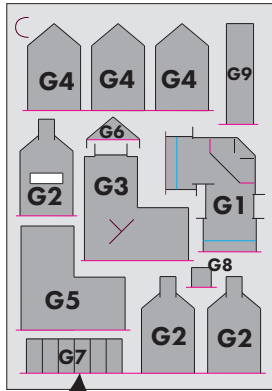

RED lines indicate score rules you need to cut to release from base sheet.

BLUE lines are fold lines. Don't cut.

Key to components:

- G1. Inner base card.
- G2. Gable walls 2 x solid 1 x with hole.
- G3. Inner 1st. floor marked with a Y.
- G4. Gables walls without chimneys x 3.
- G5. Inner upper floor.
- G6. Gable top piece.
- G7. Chimney spacers x 6.
- G8. Dormer former.
- G9. Shop sign height jig.

2 Make your 'Builder's Yard'

As you extract the components from the base sheets they need to be kept away from your working area on a thick piece of card or a tray until needed.



Example of builders yard.

3 Painting Corners and Edges.

Before you start any building work, it is best to get this job out of the way.

The white card that shows on the corners and edges doesn't have to be painted, but if you are a perfectionist it is easiest painted before you build.

All you need is a simple set of child's watercolour paints like these and a fine brush.

Mix the colours in the lid using lots of water. Use about 5 parts water to 1 part paint. You only need to just tint the card edges a little. Fold back each score line and gently run the point of your brush along the exposed edges. Wipe away any paint that bleed onto the card.



4 START BUILDING

Base Card.

Fold in half on the centre score line and glue back to back.

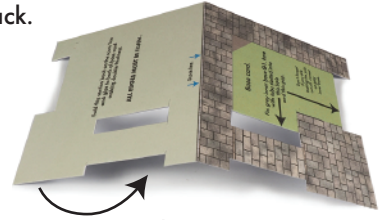

Make sure all edges are flush.

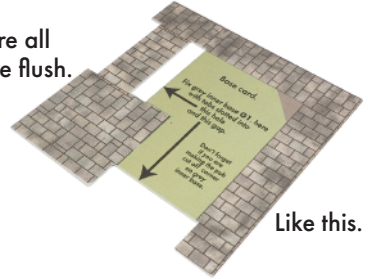

Like this.

5 Inner Base Card - G1.

This sits on top of the printed base card and acts as a guide for the outer walls.

For the SHOP use the whole card.

For the PUB cut away the corner.

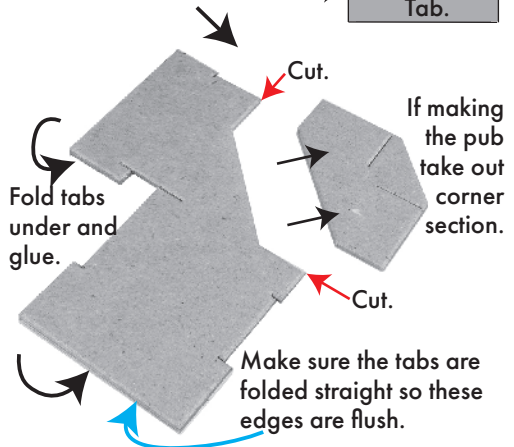
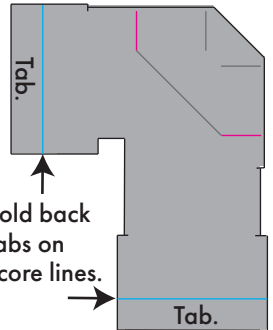

Fix onto the base with this tab sitting in the slot nice and snug.

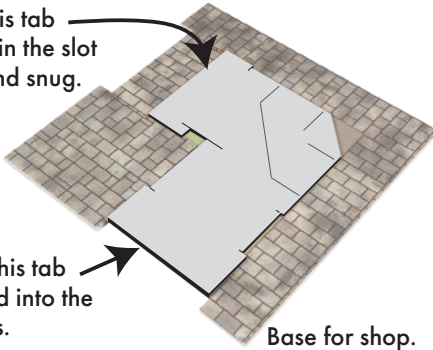

And this tab seated into the recess.

Base for shop.

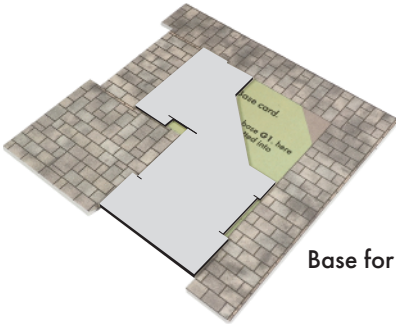

Base for pub.

6 Glazing and Window Frames.

The next job is to get all the windows made up and fitted into the building.

Each window has a window frame and corresponding glazing sheet that fits behind it.

There are 13 x WF1. glazing pieces that fit behind the 13 x WF1. window frames

There are also two smaller WF2. windows.

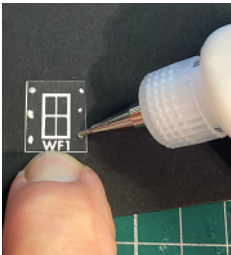

Place tiny spots of glue down each side of the glazing as shown here.



Then carefully fit the window frame on top of the glazing. Centre the glazing inside the opening.

You should end up with 11 standard WF1. windows, and two larger left and right hand windows (also WF1.) as shown here.

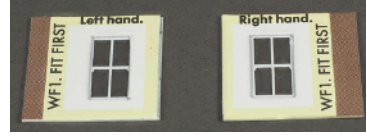

FIT THESE 2 LARGER WINDOWS FIRST.

At either end of the main building so the brown tabs protrude past the wall ends. see below

All windows fitted, note the two end tabs showing past the wall ends at either side.

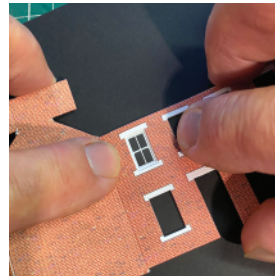

To fit the windows to the openings in the building, simply place the window on your work surface and lower the wall carefully down on to it.

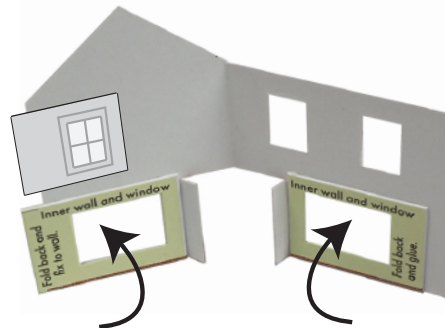

Fold the two yellow inner windows upwards and fix to the back of wall.

These act as window frames for the glazing

Fix the shop window glazing of your choice to back of openings.

IF YOU ARE MAKING A PUB - Don't fit the shop window glazing. see 7

Fix the remaining WF1. windows to the upper openings in the rear building.



The two smaller WF2. windows fit to the lower window openings in rear building.

7 SHOP OR PUB?

The main building shown in the previous column is as it needs to be if you want to make a Corner Shop.

If you want to make the pub you need to cut away the window bottoms and corner door walls before you attach any more glazing.

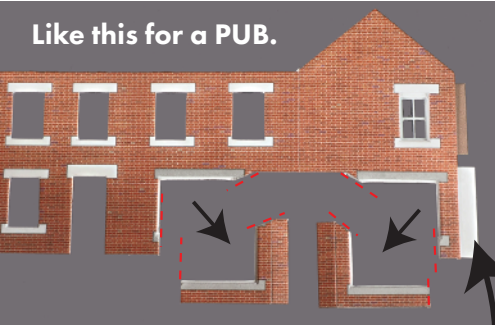

The inner window frames still need to be folded up though, as in previous column.

This keeps the white fixing tab here. It also strengthens the wall and leaves a ledge for the inner 1st. floor to sit on.

Everything else is just the same as the shop.

Instructions for making the pub frontage are in section 20

CURTAINS

If you want to put curtains in the windows now is the time to fit them See Page 16. for full details.

8 The Doors.

If you look at the bottom edge of the main building, you will notice that the front and back walls are 1mm. shorter than the gable walls. This is to allow the gables to sit snugly down over the edge of the base card and the front and rear walls to sit on top of the base card.

It is imperative that when you fit the doors and the door frames, they don't protrude past the bottom edges of the walls.

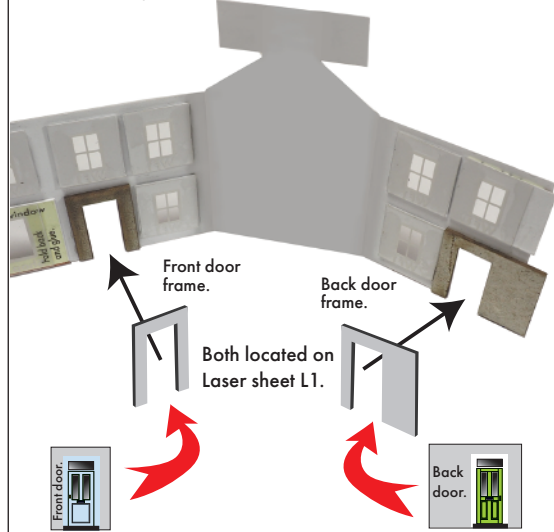

Fit the frames to the back of the door openings with the inner edges lined up. Then fix on the appropriate door.

The back door, you will notice, is wider and sticks out past the wall end. As window above.



Back door.



Front door.

The Shop Door

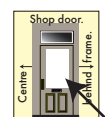

has a small opening in it, but there is no glazing. So simply cut a piece of waste plastic from the edge of the glazing sheet and fit behind opening. Place door to one side for now.

9 Inner Gable Wall.

Fix the 3 x G2. grey card inner gable walls together to form a solid block

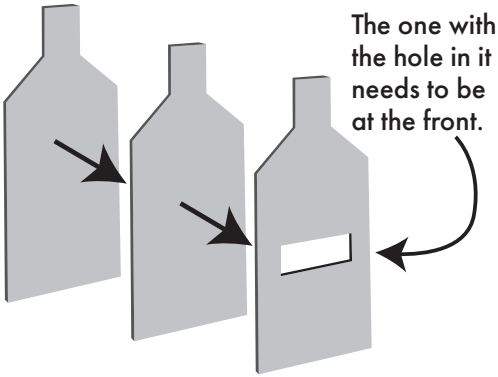

ALL OUTER EDGES MUST BE FLUSH.

This is very important take lots of care that you get them lined up.

Now fix it to the back of the gable wall on the main building

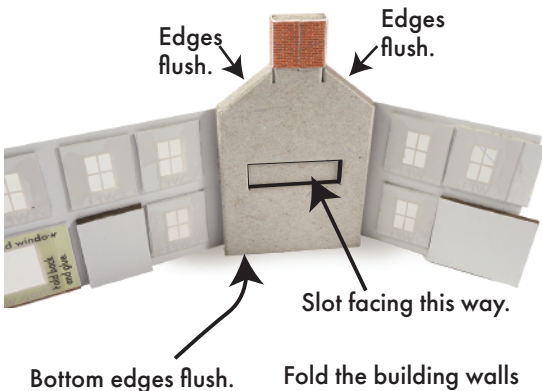

Fold the building walls around to make sure it is positioned correctly.

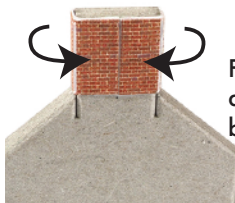

Fold the chimney stack around and fix with edges butt ended together.

10 Inner 1st. Floor. (G3)

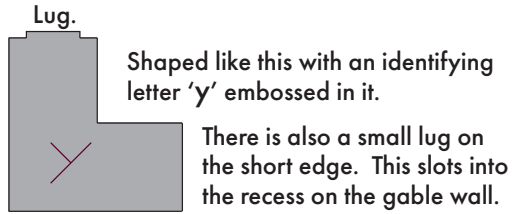

Now carefully wrap the building around the inner floor. The floor sits on top of the doors and the two shop window frames.

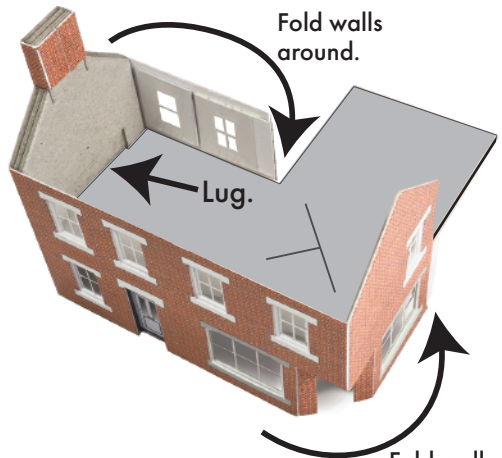

The lug slots into the recess on the gable wall pushed down to the bottom edge.

Fold walls around.

Try this without glue a few times so you see just how it fits inside the building and which edges to apply glue to.

11 Shop Doorway.

This is a tricky one, and needs fitting with care.

The corner of the building where the door fits at this stage is a little floppy, but once the door frame is fixed to the back of the opening, then the corner is held more rigid and the door can be fitted with ease.



Fit the laser cut door frame to the back of the two walls that fold inwards on the corner of the opening. Carefully line up each wall with the inner edge of the door frame.

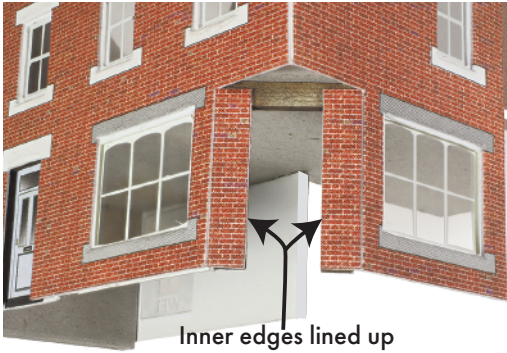

Inner edges lined up

Once fast will hold lower corner of the building to the correct shape

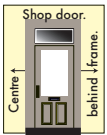

Shop door fitted from behind.

12 Window Displays.

These need fitting to the base card before you fit the building.

Choose the display to go with whatever sign you will be using.

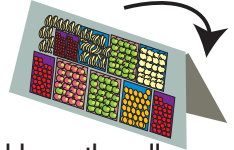

Fold over the yellow tab at the top so that it stands on its own.

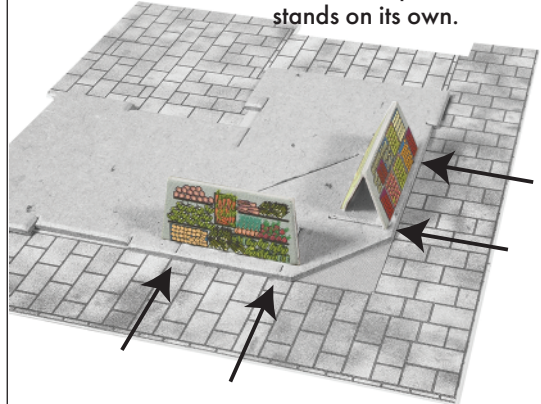

Using the embossed lines in the grey base card which line up with the windows, place your window displays as shown standing about 1 or 2mm. back from the edge.

Fit window posters as well if needed.

Now you can fix the building on to the base.

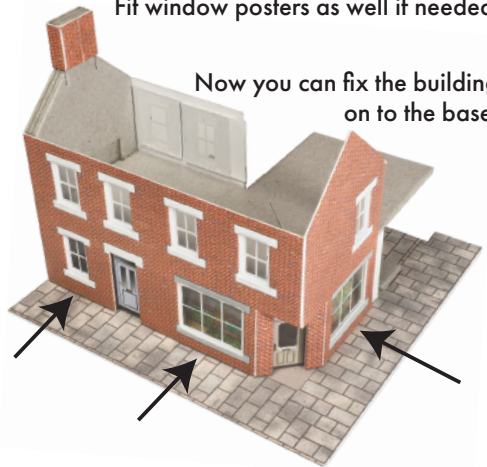

Again, test without glue first so you are familiar with just where it sits. Place tiny spots of glue around the inside bottom edges of the walls and doors. Fit over the grey base and push the walls gently against the base until glue is fast.

13 The Rear Building.

Starting with the inner gable walls G4.
(without chimneys)

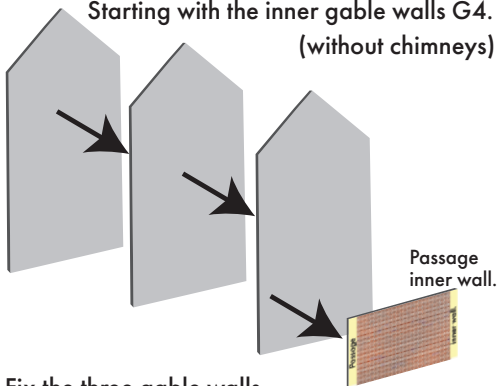

Fix the three gable walls together all edges flush as you did with the other gable. Then fix the passage inner wall onto the gable with side and base edges flush.

Fix to the inside of the rear building gable wall.



Now fold the walls up to the inner gable at right angles

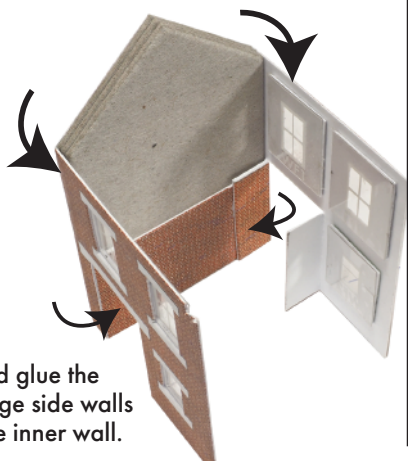

Fold in and glue the two passage side walls against the inner wall.

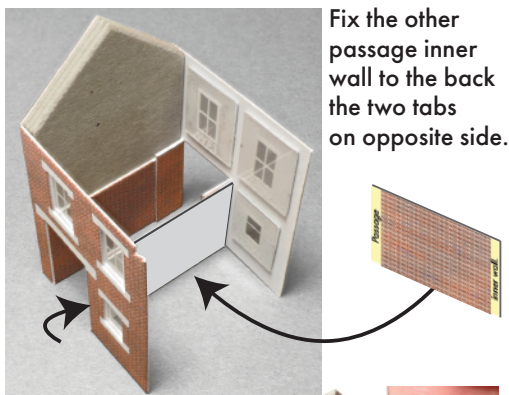

Fix the other passage inner wall to the back the two tabs on opposite side.

A fiddly job made easier if you clamp each side with tweezers, like this.



Keep bottom edges flush.

14 Fit the Rear Building.

Slide the rear building into place with the gable wall sitting in the recess in the base.

Push into corner and fix.

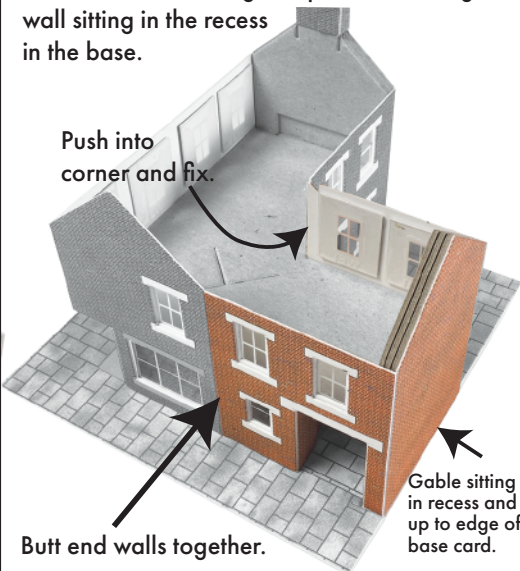

Butt end walls together.

Gable sitting in recess and up to edge of base card.

Try without glue first. If you can't get the rear building to fit tight up to the main building, try cutting a little piece off the end of the grey inner floor.

Now fit the Upper Inner Floor **G5**, which sits inside the building on top of the windows.

Also fit the small Gable top piece **G6**.

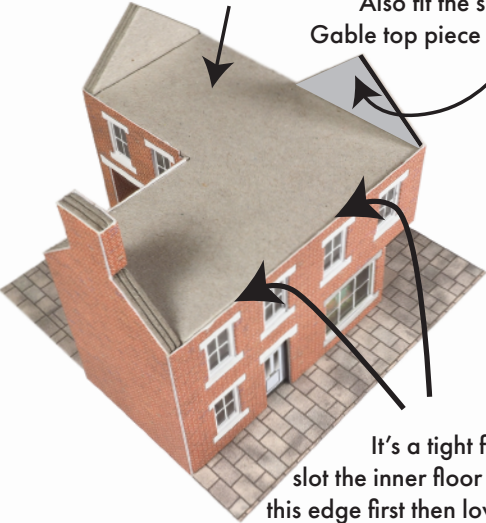

It's a tight fit so slot the inner floor into this edge first then lower it down inside the building.

15 Fit the Roof.

Push tight up under the chimney stack.

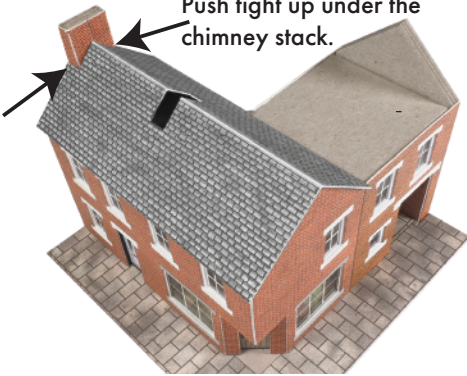

Fit rear roof. Place tiny spots of glue along the underside edge of angled roof to fix it onto the main roof. Hold till fast.



16 Chimney Stacks

Take 3 x **G7**. chimney spacers and glue them together in a block with all edges squared up.

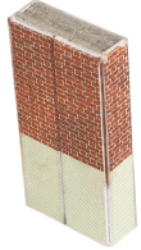
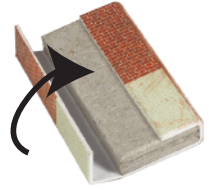
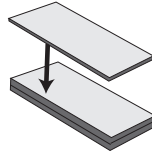

Wrap the chimney stack around the block. Top edge flush with the inner block.

Put to one side for now.

17 Ridge Tiles Strips.

The ridge tile strips are all cut to the correct lengths for the four ridges. Each one has a score line running along the centre. Locate these and fold each one in half. Paint the white card along the fold.



This ridge needs one end cutting to fit at 45° where it fits up to the main roof.

Cut a small 'V' notch out of this strip

V notch.

18 Shop Signs.

From Laser sheet L1. locate and extract when needed:
2 x 'L' shaped sign braces

NOT THE THICKER ONE next to them that's for the pub.

Also 4 x tiny sign ends.

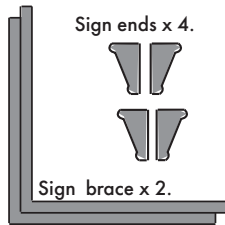

The two black shop sign spacers need to be fixed to the wall using the grey G9. jig to set them at the correct height and keep them level. The two spacers should meet touching on the corner.

Shop sign spacer.



Fit one 'L' shaped sign brace sitting directly on top of the black sign spacers and fixed to wall.



Now extract one black 'Shop sign top' from SHEET B.

Fix it on top of the of the laser cut sign brace Again pushed tight up against the wall.

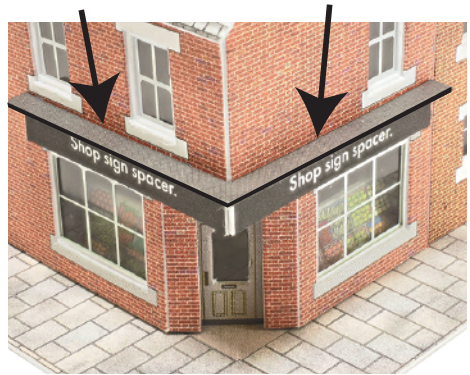

Now fit the sign of your choice wrapped around the corner.



To fit the sign at the correct angle the top of the sign fits against the laser cut sign brace and the underside of the sign top.

If you look at it from the side view it should look like this

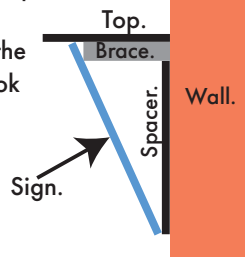

On Laser sheet L1,
extract the sign ends



Push two out
and fix them to
each end of the
sign - here.



The sign ends look good if they are painted
black on both sides before fitting.



You can now fit the doorsteps also located on
Laser sheet L1.



Roller Shutters.

Bring your shop up to date, cut out and stick
over your shop windows and door.
(Good if you've made a hash of things!).



19 Back Yard Wall.

Fold over the two inner sections
of the yard walls and glue to
the backs to make
double thickness.

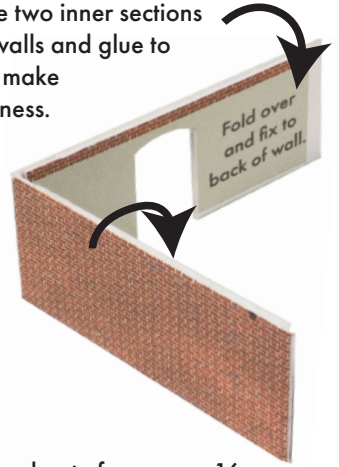

Cut out the yard gate from page 16.
Score and fold along the dotted line and glue
to make double sided.

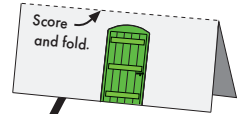

Fit to the back of
the gateway openings.

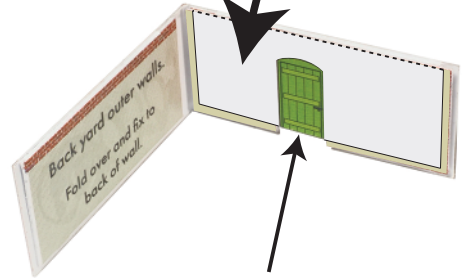

Position to the top of the openings so that you
leave a gap along the bottom edges.

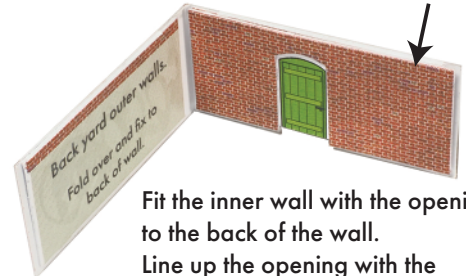

Fit the inner wall with the opening
to the back of the wall.
Line up the opening with
the gate and the wall top.

FIX WALL TO BASE CARD

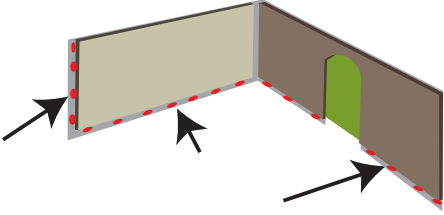

When fitting, place tiny spots of glue along the inside edges of the walls shown here as red dots.

Fit the wall around the yard base. The inner walls sit on top of the base and the longer outer walls fit to the outer edges. The wall ends fit into the crease in the corner of the house walls.

Once the walls are in place and the glue has set fit the other inside wall.

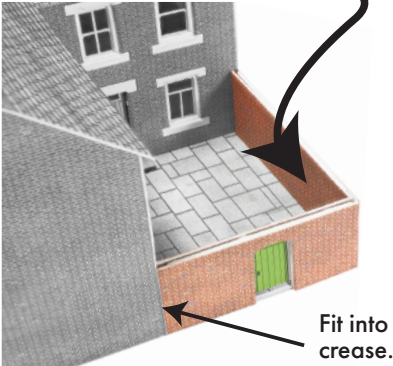

Fit into crease.

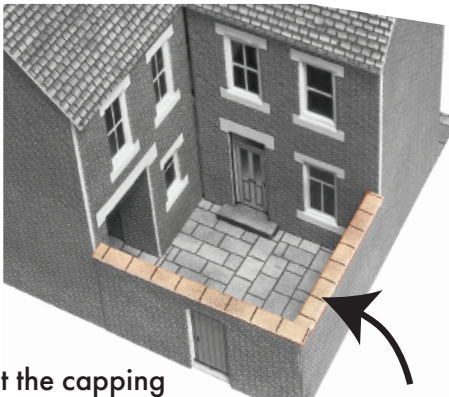

Cut the capping stone strips to length and fit on to the wall tops.

20 Making a Pub.

Up to this point everything in the construction of the building is the same as the shop. Fit the building to the base card and you have a structure like this, but with the corner cut away like this.



The pub frontage is built up as a separate unit and attached onto the corner when it is complete.

From **SHEET B**, extract these components:

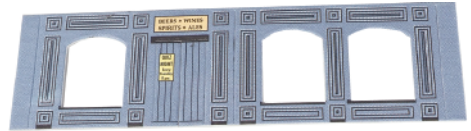

Frontage wall.



Pub door.

Pub door back and side former.

Fold.



Window curtains.

And from Laser sheet **L1**, extract these components:

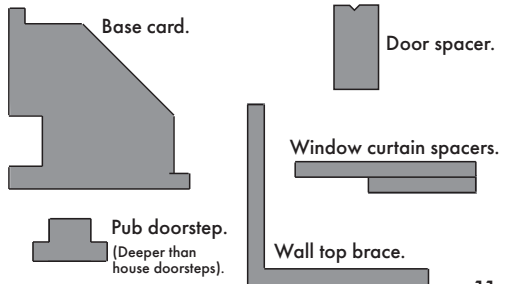

Base card.

Door spacer.

Window curtain spacers.

Pub doorstep.
(Deeper than house doorsteps).

Wall top brace.

Fold corners and door sides.

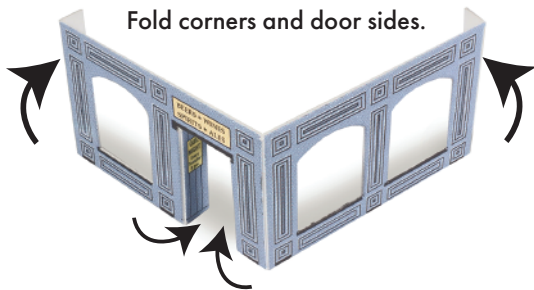

Attach the glazing to window openings.



Make up the doorway

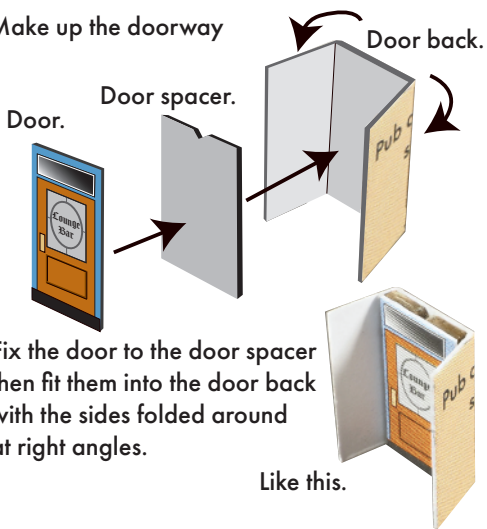

Fix the door to the door spacer then fit them into the door back with the sides folded around at right angles.

Like this.

Then fix it onto the door side openings on the pub wall.

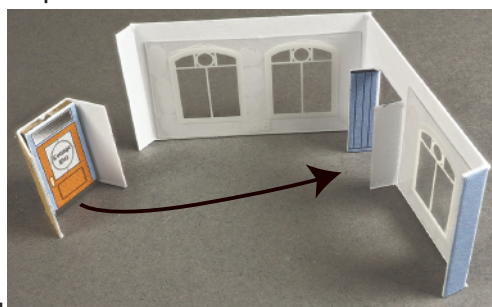

Like this

Now fit the pub frontage walls around the base card.

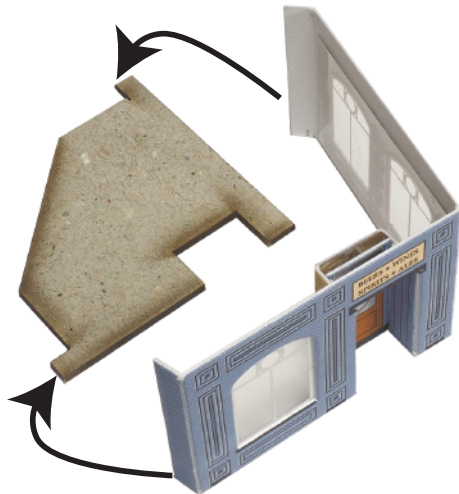

Like this with the short end walls tucked round at right angles.



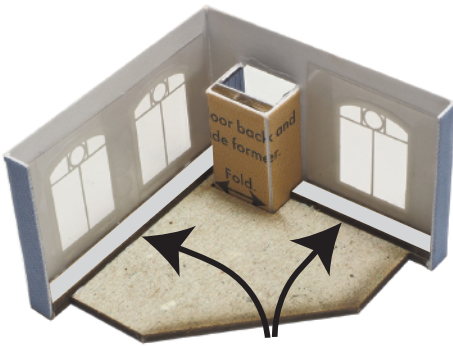

Fix the window curtain spacers up tight against the walls as shown.

The laser cut wall top brace fits just inside the walls flush to the top edges.

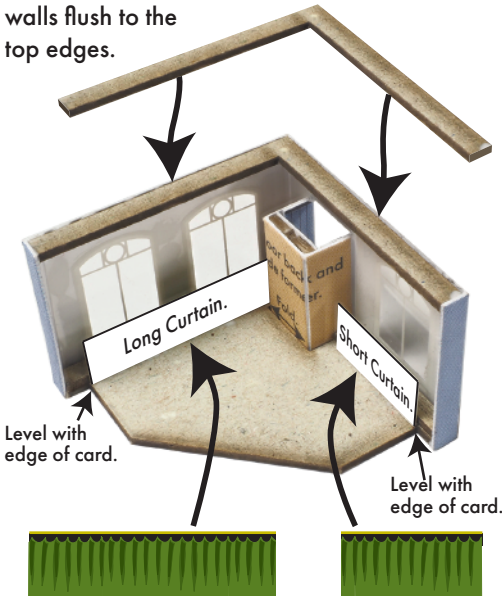

Level with edge of card.

Level with edge of card.

Fit the curtains stood upright against the spacers, with printed side facing through the windows.

The finished job.



Fix it to the corner of the building

Fit the pub frontage roof (located on SHEET B).



Fit the doorstep and don't forget the pub signs.



See other optional embellishments to add on such as dormers and bay windows on next page.

Use along side our Terraced Houses kits



Also available in stone finish
PN104 Terraced Houses
PN117 Corner Shop/Pub.

21 Dormers & Bays.

The Dormer Window.

Fix the grey square dormer former card **G8** onto the roof about 3 rows of slates down from the ridge tiles.

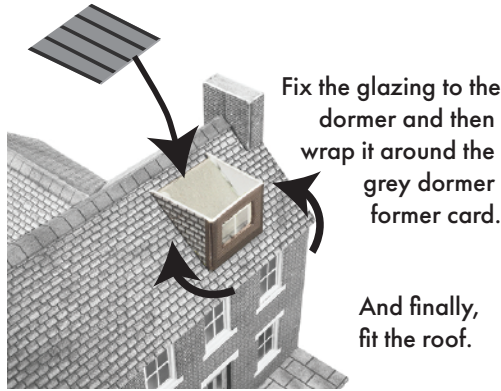
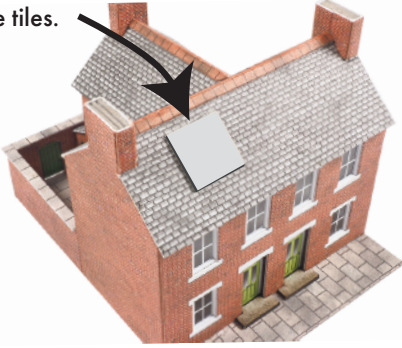

Fix the glazing to the dormer and then wrap it around the grey dormer former card.

And finally, fit the roof.

The Bay Window.

Fold the two score lines between the windows.

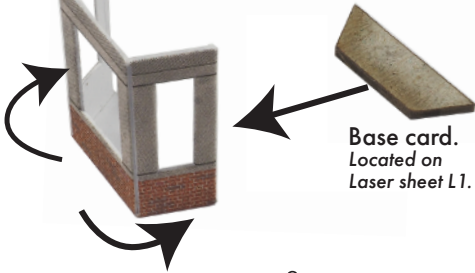

Base card.
Located on
Laser sheet L1.



Window covering
blackout sheets x 2

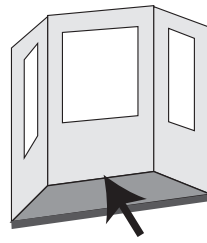

Now fit the laser cut inner brace to the base of the bay to hold it in shape like this.

Score the glazing along the two dotted lines and bend it to the shape of the bay window.

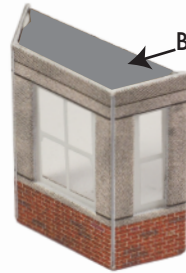
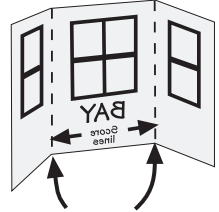

Brace.

Fix the glazing inside the bay and then attach the other laser cut brace into the top.

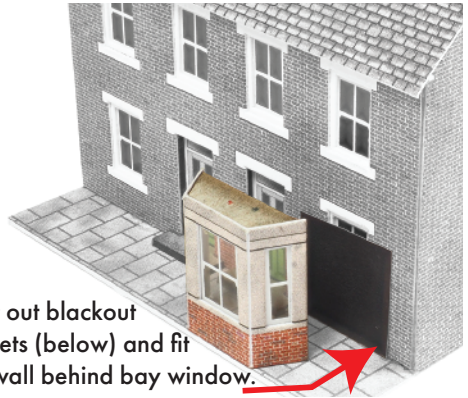

Cut out blackout sheets (below) and fit to wall behind bay window.

Fix the bay roof.

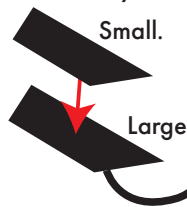

Small.

Large



22 Chimney Pots.

Cut out the terracotta coloured strips (overleaf) roll each one tightly around a metal rod to form a cylindrical shape.

Drill bits, nails or knitting needles can be used. About 2.5mm. in diameter for N scale though.

Roll the strip around the metal rod.
Roll up tight and keep rolling until the paper is fully curled around.
Then unroll the end back out just enough to smear with a little glue.
Roll back up, hold tight until glue sets.



Keep edges straight.

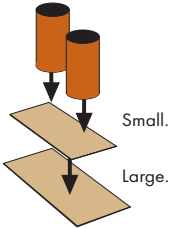

Small.

Large.

Another fiddly job
but well worth the effort.



Mount the pots on to the chimney capping stones before fixing to the main chimney stacks. Slot into the openings in the roof.



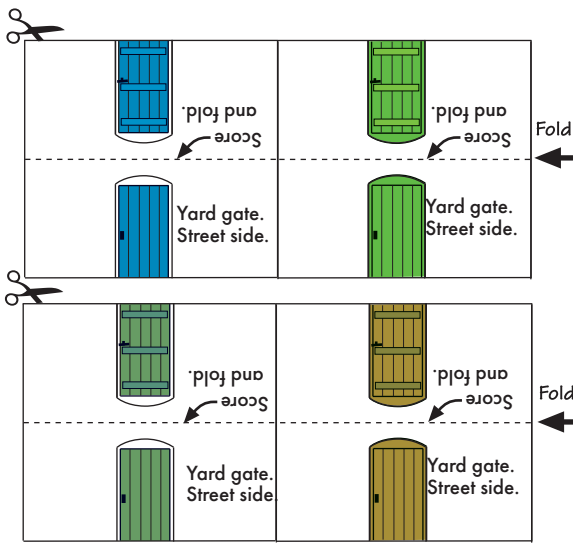

Yard gates.

If you want the gate to open, cut along the top and down one side. Score the hinged side and bend. This is best done before fitting to the wall.

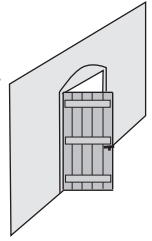

Curtains.

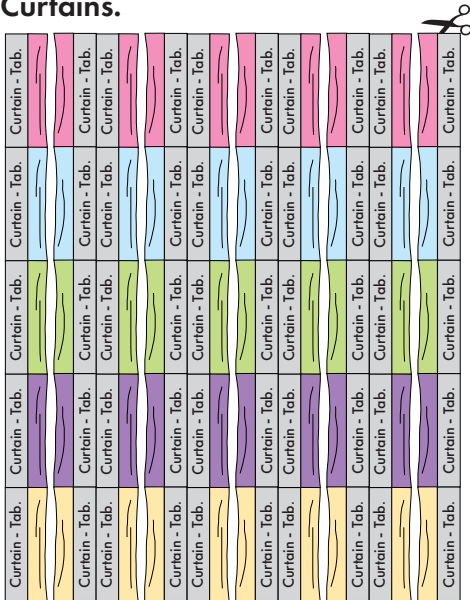

23 Curtains.

The curtains are an optional extra that require a lot of intricate work to complete, but they give the house a nice finishing touch.

To fit the curtains fix a small strip of waste card no more than 15mm. long and about 4mm. wide down each side of the window.

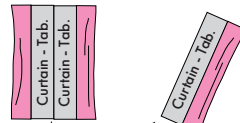

Cut out each individual curtain.

Waste card cut to 15mm. deep x 4mm. wide to space curtain back from the glazing.

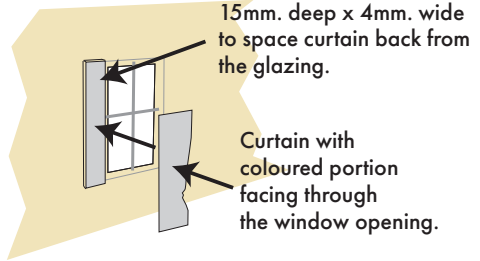

Fit waste card down each side of the window. CAUTION: Don't allow it to overlap the edges of the window frame, as it may hinder the fitting of inner floors.

Chimney pots

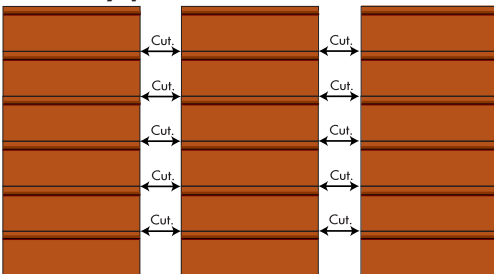

Blinds & Net Curtains

This is simple, just cut a small piece of white paper and stick it on the side spacers.

Waste card spacers.

