

McDonnell XP-67 Moonbat

1/72 scale resin model kit #AA-2056

In 1939, USAAF issued a specification "R-40" for a long-range twin-engine fighter. McDonnell submitted company's first design but was rejected. McDonnell modified the design and resubmitted to USAAF in 1941. This time it was accepted and received order for two prototypes, designated XP-67. The XP-67 was created for unusual looking that the fuselage and the engine nacelles were merged together in order to maintain maximum aerofoil sections throughout the entire airframe. Due to the engine delay, first flight was not happened until January 1944. Handling was judged well but the engine problem led to its performance being unsatisfactory. In September 1944, during its 43rd hour flight test, the troublesome engine got in-flight fire. Although the plane was landed safely, it was completely lost by fire burn. Afterward, McDonnell and the USAAF agreed to terminate the XP-67 project. The second prototype was never finished.

Specifications:

- Wingspan - 55ft.
- Length - 44ft.9in.
- Height - 15ft.9in.
- Powerplants - 2x Continental XI-1430-17/19
- Crew - 1
- Max speed - 405 mph
- Armament - 6x 37mm cannon (planned in wing root)

The XP-67 revealed the futuristic aerodynamic design, the engine nacelles linked smoothly with the fuselage in trapezoid shape.

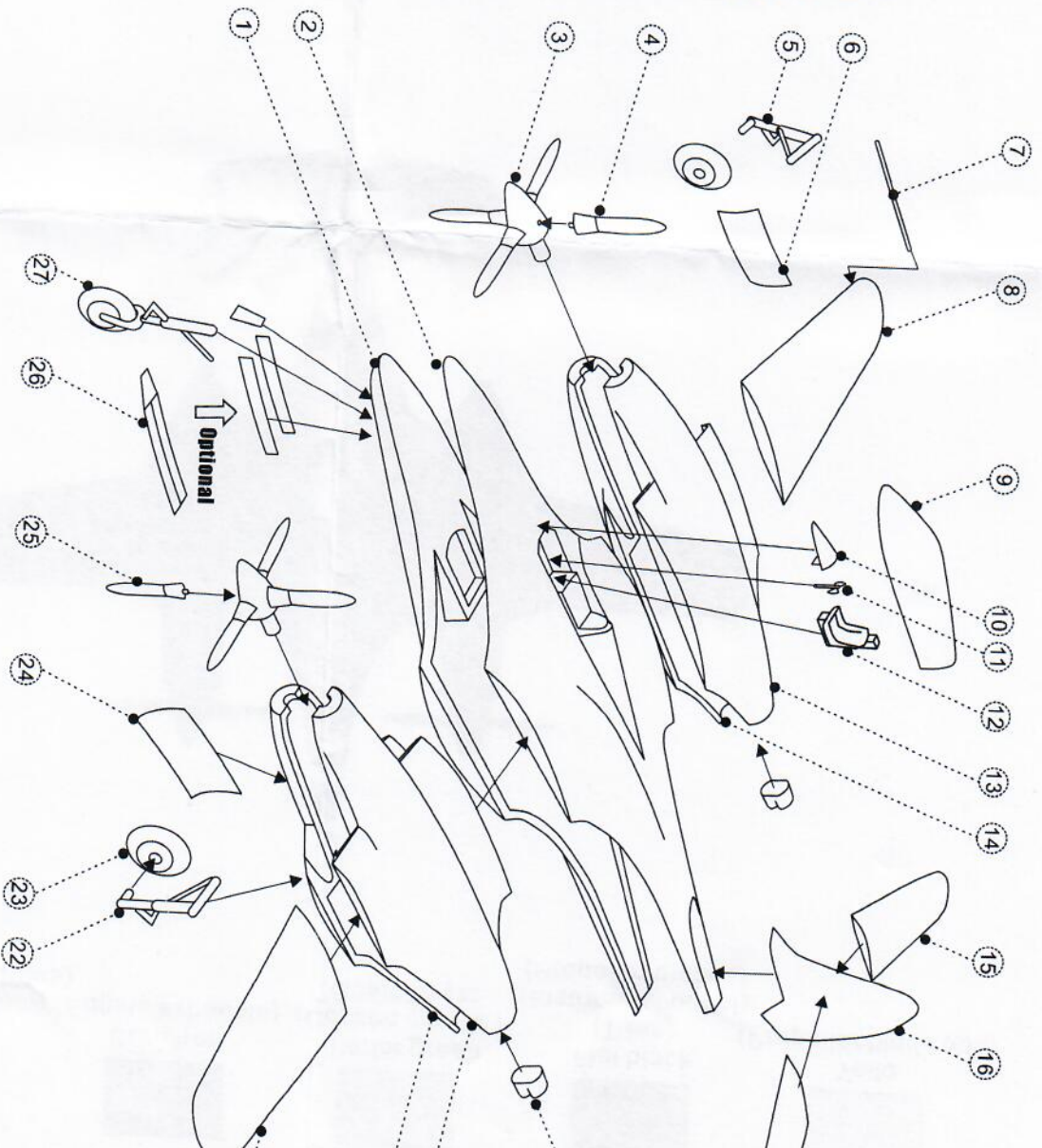





- 1 Fuselage bottom x 1
- 2 Fuselage top x 1
- 3 Propeller spinner x 2
- 4 Starboard propeller blade x 4
- 5 Starboard main landing gear x 1
- 6 Starboard main gear door x 1
- 7 Aerial x 1
- 8 Starboard main wing x 1
- 9 Canopy x 1
- 10 Instrument panel x 1
- 11 Control lever x 1
- 12 Pilot seat x 1
- 13 Starboard nacelle top x 1
- 14 Starboard nacelle bottom x 1
- 15 Starboard tail plane x 1
- 16 Fin x 1
- 17 Port tail plane x 1
- 18 Engine exhaust pipes x 2
- 19 Port nacelle top x 1
- 20 Port nacelle bottom x 1
- 21 Port main wing x 1
- 22 Port main landing gear x 1
- 23 Main wheel x 2
- 24 Port main gear door x 1
- 25 Port propeller blade x 4
- 26 Nose gear door x 1
- 27 Nose landing gear x 1

ANIGRAND

CRAFTS WORK

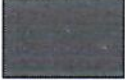
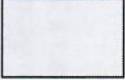
PO Box 40, Texaco Road, NT,
Hong Kong.
E-mail : email@anigrand.com
Web : <http://www.anigrand.com>

Painting & Decals

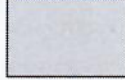
- | | | | | | |
|----------------------------------------------------------------------------------|-----------------------------------------------------------------------------------|-----------------------------------------------------------------------------------|-----------------------------------------------------------------------------------|-------------------------------------------------------------------------------------|-------------------------------------------------------------------------------------|
|  |  |  |  |  |  |
| Olive Drab
(Fuselage top) | Mid grey
(Fuselage bottom)
(Landing Gears doors) | Burn Iron
(Engine exhausts) | Interior green
(Cockpit interior)
(Gears bays) | Flat black
(Tires)
(Instrument panel)
(Propeller blades) | Yellow
(Propeller blade tips) |

