



KIT 2353

85235300200

# '70 Torino Cobra

There is a certain breed of car that is made to do one thing...go fast. With an all-new sleek body design introduced in 1970, the Torino Cobra Jet is one of those cars that looks like it's moving when it's standing still. The 428 Cobra Jet engine promises a car that will stay far ahead of the competition and the Torino delivers on that promise.

Goes fast, looks good... isn't that what a muscle car is all about?



\* REPEAT SEVERAL TIMES  
\* A REPETER PLUSIEURS FOIS



\* OPTIONAL PARTS  
\* PIECES EN OPTION



\* DECAL  
\* DECAL COMANIE



\* ALTERNATIVE ASSEMBLY  
\* ENSEMBLAGE ALTERNATIVE



\* CEMENT TOGETHER  
\* A COLLER



\* REMOVE AND THROW AWAY  
\* A RETIRER ET JETER



\* DO NOT CEMENT  
\* NE PAS COLLER

## READ THIS BEFORE YOU BEGIN

- \* Study the assembly drawings.
- \* Each plastic part is identified by a number.
- \* In the assembly drawings, some parts will be marked by a star (★) to indicate chrome plated plastic.
- \* For better paint and decal adhesion, wash the plastic parts in a mild detergent solution. Rinse and let air dry.
- \* Check the fit of each piece before cementing in place.
- \* Use only cement for polystyrene plastic.
- \* Scrape plating and paint from areas to be cemented.
- \* Allow paint to dry thoroughly before handling parts.
- \* Any unused parts may be discarded.

### DECAL APPLICATION INSTRUCTIONS

1. Cut desired decal from sheet.
2. Dip decal in water for a few seconds.
3. Place wet decal on paper towel.
4. Wait until decal is movable on paper backing.
5. Place decal in position on model, face up and slide backing away.
6. Press out air bubbles with a soft damp cloth.
7. Milkiness that may appear is for better decal adhesion and will dry clear. Wipe away any excess adhesive.
8. Do not touch decal until fully dry.
9. Allow the decals 48 hours to dry before applying clear coat.

**NOTE:** Decals are not compatible with setting solutions or solvents.

## LIRE CE QUI SUIT AVANT DE COMMENCER

- \* Etudier les schémas de montage.
- \* Chaque pièce en plastique est identifiée par un numéro.
- \* Sur les schémas de montage, certaines pièces sont marquées d'une étoile (★) pour indiquer qu'elles sont en plastique chromé.
- \* Pour une meilleure prise de la peinture et des autocollants, laver les pièces en plastique avec une solution détergente peu concentrée. Les rincer et les laisser sécher à l'air.
- \* Vérifier que chaque pièce s'ajuste bien avant de la coller en place.
- \* N'utiliser que de la colle pour polystyrène.
- \* Gratter les parties à coller pour enlever le chrome et la peinture.
- \* Laisser la peinture bien sécher avant de manipuler les pièces.
- \* Toute pièce inutilisée peut être jetée.

### DIRECTIVES D'APPLICATION DES AUTOCOLLANTS

1. Découper l'autocollant désiré de la feuille.
2. Tremper l'autocollant dans de l'eau pendant quelques secondes.
3. Placer l'autocollant mouillé sur une serviette en papier.
4. Attendez que l'autocollant puisse être déplacé sur son support en papier.
5. Mettre l'autocollant en position sur le modèle face sur le dessus et faire glisser le support pour l'enlever.
6. Appuyer avec un chiffon doux humide pour éliminer les bulles d'air.
7. La substance laiteuse qui peut apparaître est destinée à améliorer l'adhésion de l'autocollant et devient incolore au séchage. Essuyer pour enlever tout excédent d'adhésif.
8. Ne pas toucher l'autocollant tant qu'il n'est pas bien sec.
9. Laisser l'autocollant sécher pendant 48 heures avant d'appliquer une couche transparente.

**REMARQUE:** Les autocollants sont incompatibles avec les solutions de fixation ou les solvants.

**This paint guide is provided to complete this kit as shown on the box.**

*Ce guide de peinture est fourni pour reproduire le modèle réduit qui apparaît sur la boîte.*

Aluminum	Aluminum
Flat Black	Noir mat
Flat White	Blanc mat
Ford Engine/GM Blue	Blue moteur Ford et GM
Gloss Black	Noir lustré
Gloss Red	Rouge lustré
Gloss Yellow	Jaune lustré
Satin Black	Noir satin
Silver	Argent
Steel	Acier
Transparent Red	Rouge transparent
Turn Signal Amber	Feu de virage ambre

If you have any questions or comments, call our hotline at: **(800) 833-3570** or, please write to:

**Revell-Monogram Consumer Service Department, 8601 Waukegan Road, Morton Grove, Illinois 60053**

Be sure to include the plan number (85235300200), part number, description, your return address and phone number.

Visit our website: [www.revell-monogram.com](http://www.revell-monogram.com)

# 1

# ENGINE ASSEMBLY

**A**

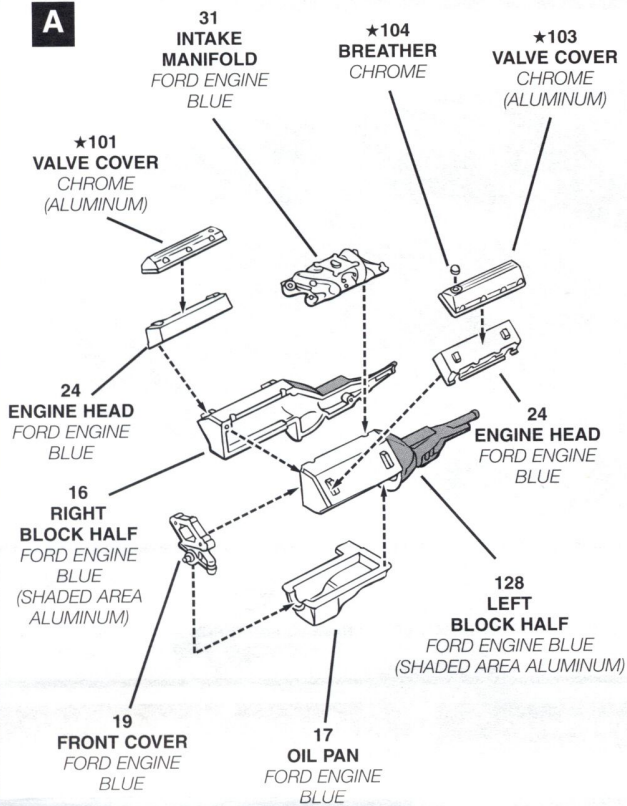

**B**

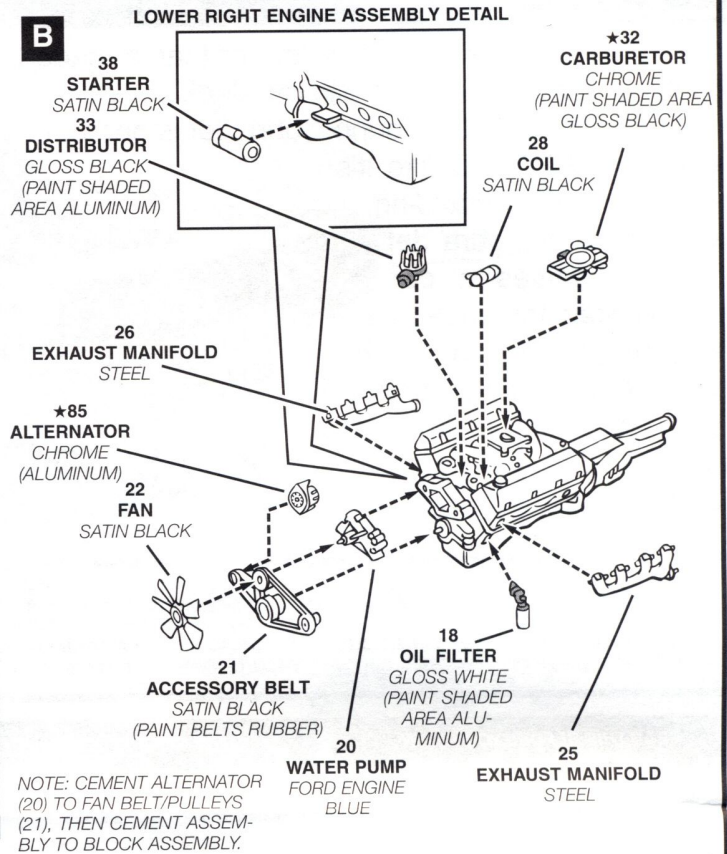

# 2

# CHASSIS ASSEMBLY

**A**

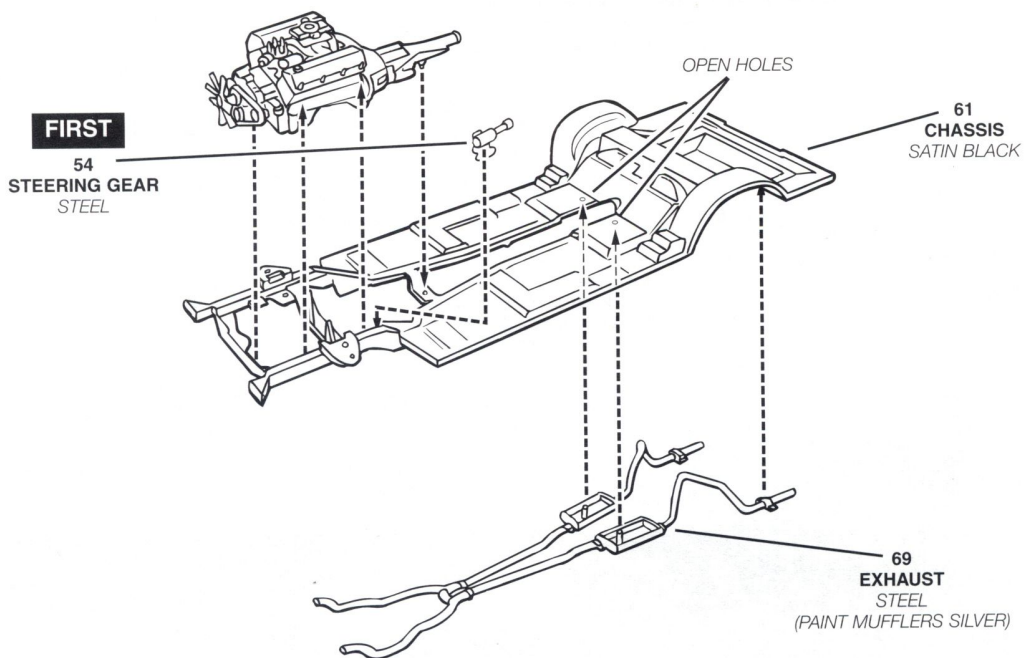

# CHASSIS ASSEMBLY

**B**

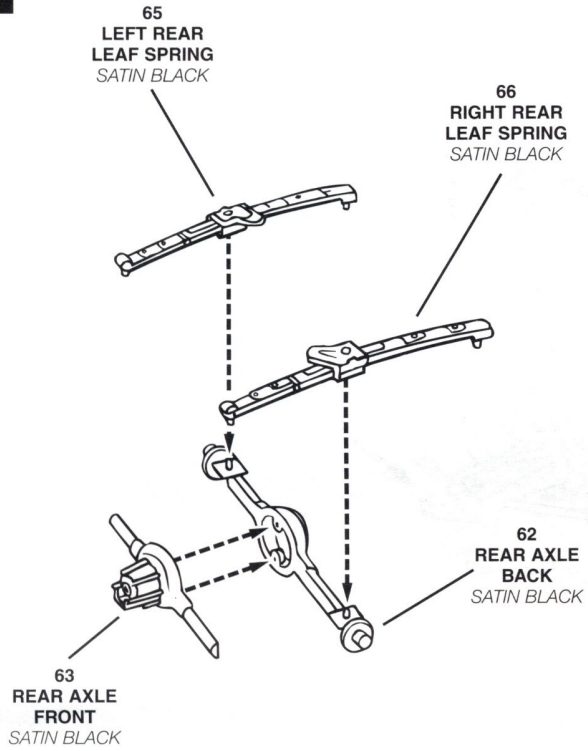

**C**

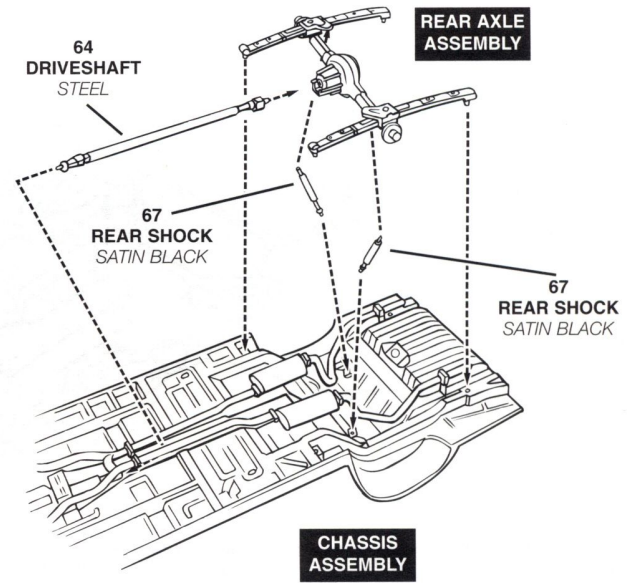

**D**

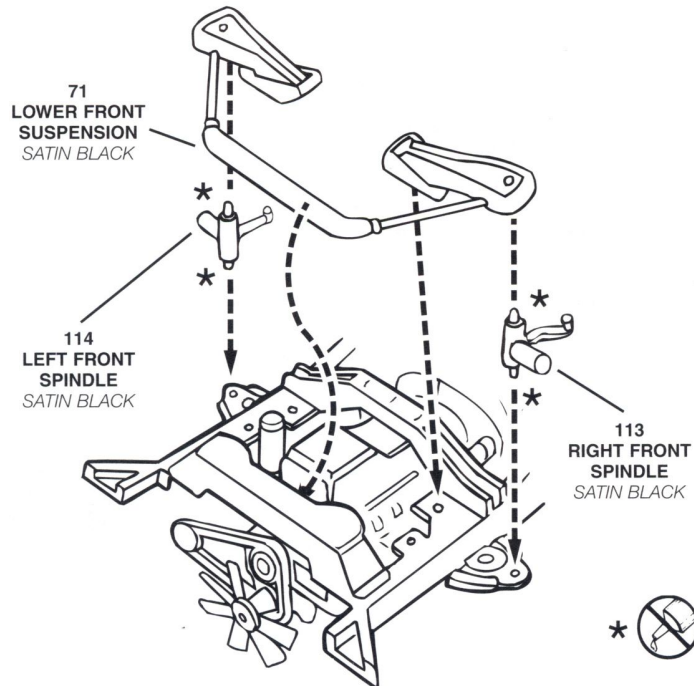

# 2

# CHASSIS ASSEMBLY CONTINUED

E \* 

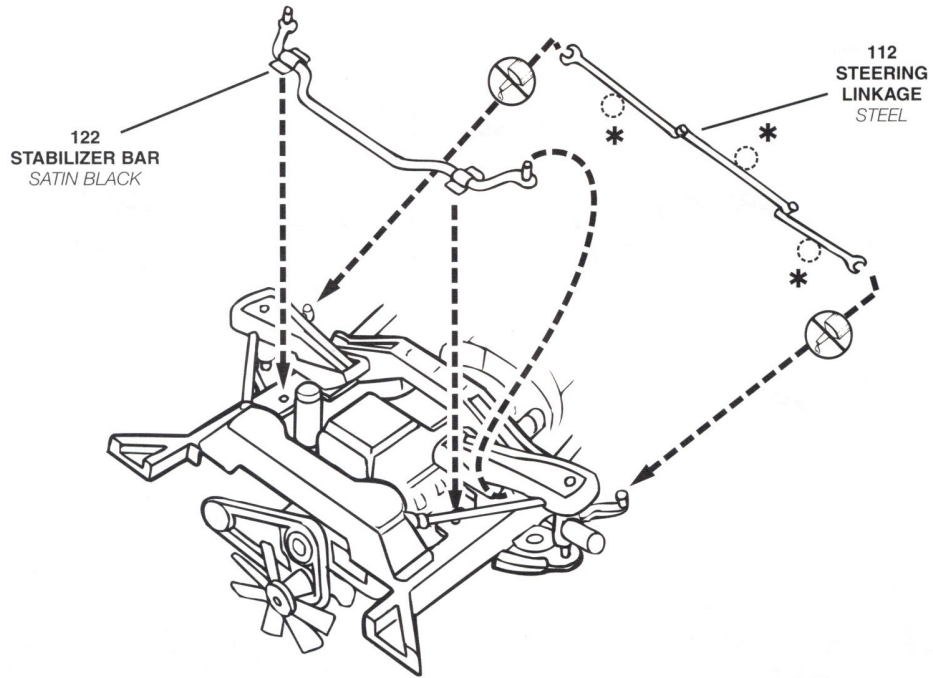

# 3

# WHEEL ASSEMBLY

A (2X)

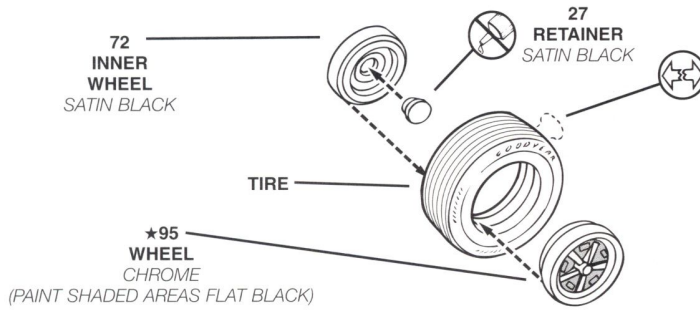

B (2X)

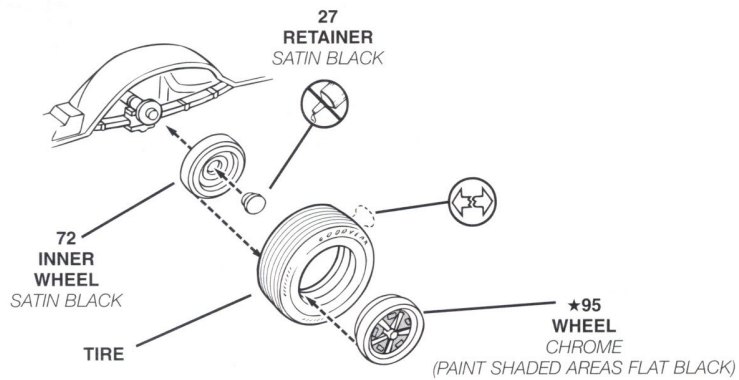

# 4

# INTERIOR ASSEMBLY

**A**

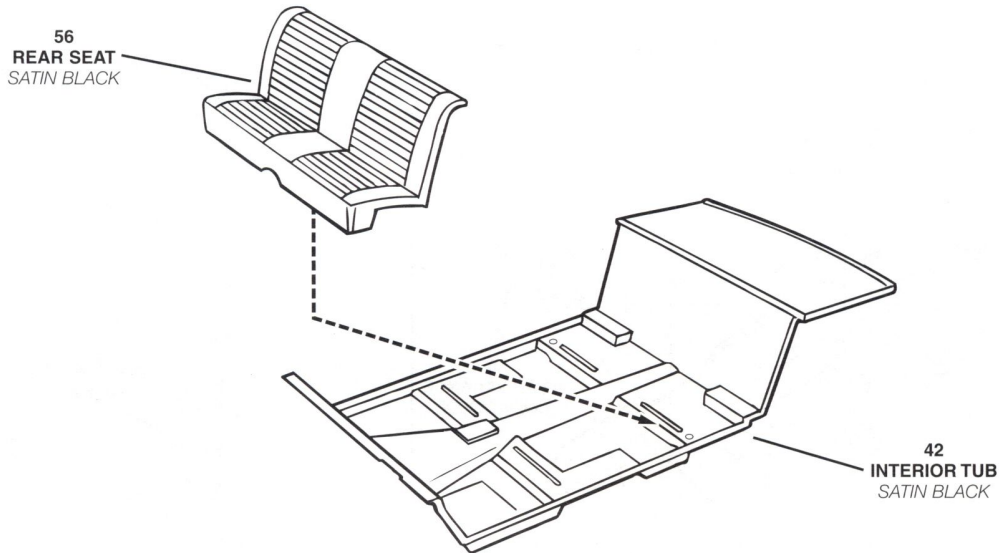

**B**

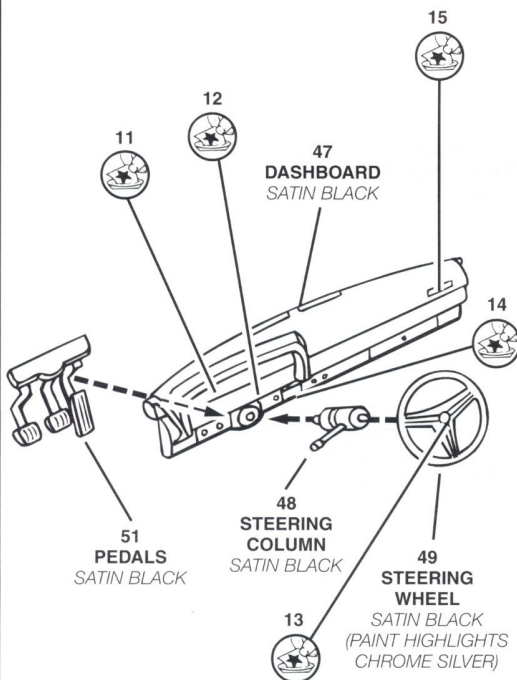

**C**

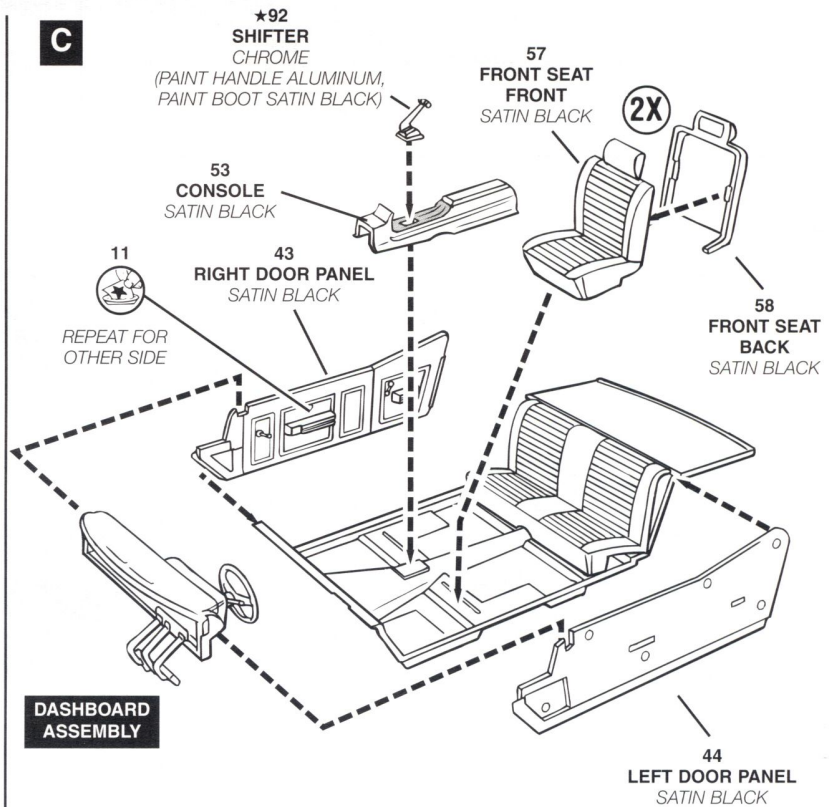

# 5

# BODY ASSEMBLY

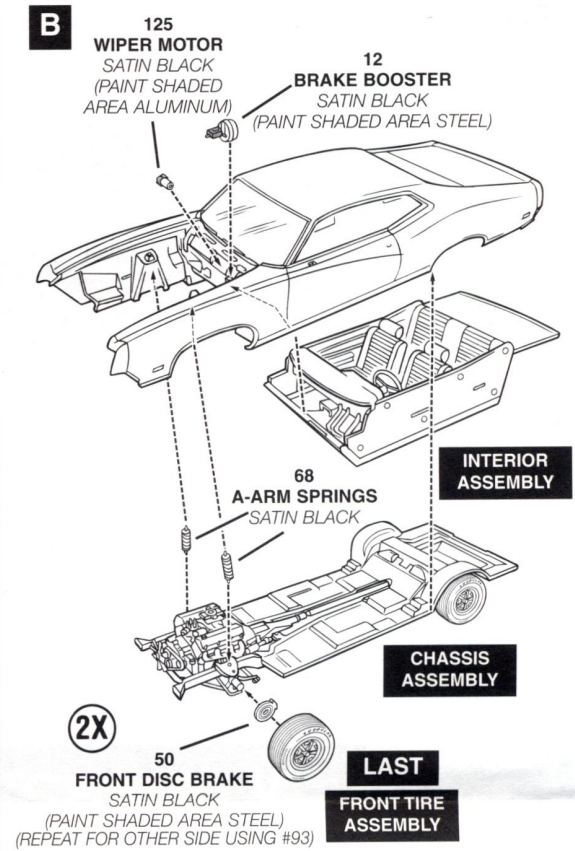
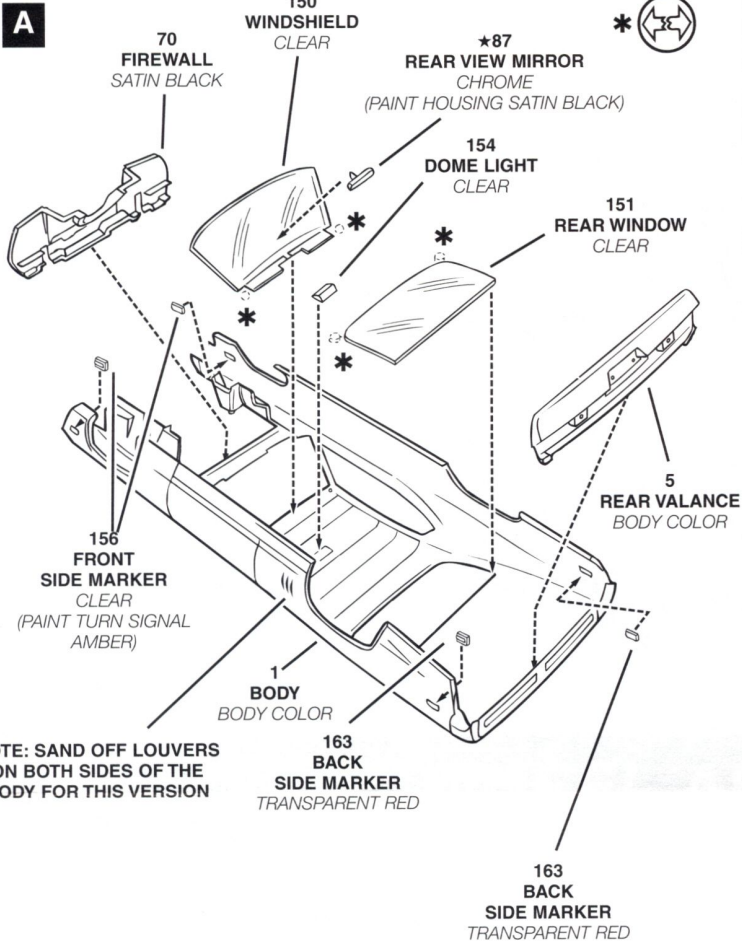

NOTE: WITH FRONT WHEEL ASSEMBLIES OFF, FIRST CEMENT SPRINGS (68) TO UPPER A-ARMS, THEN INSERT CHASSIS INTO BODY MAKING SURE THAT A-ARM SPRINGS LINE UP WITH HOLES IN BODY FENDER PANELS

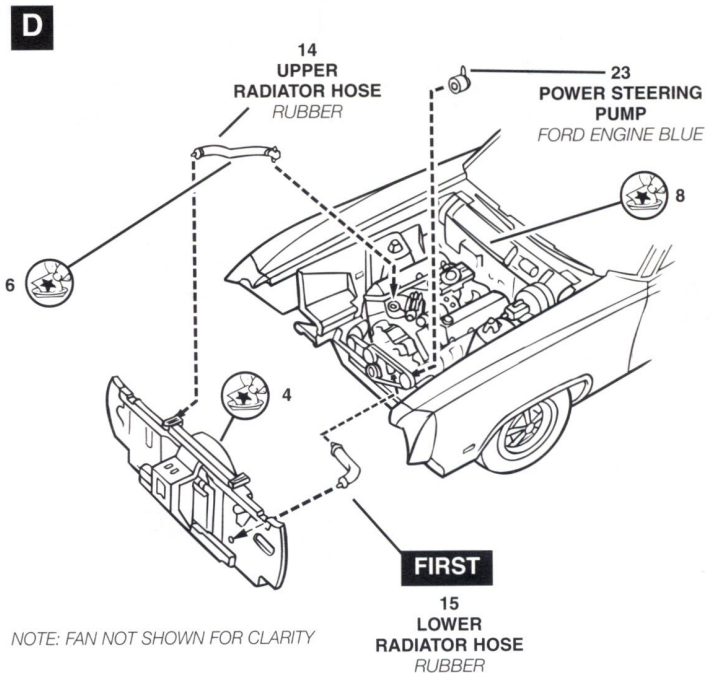
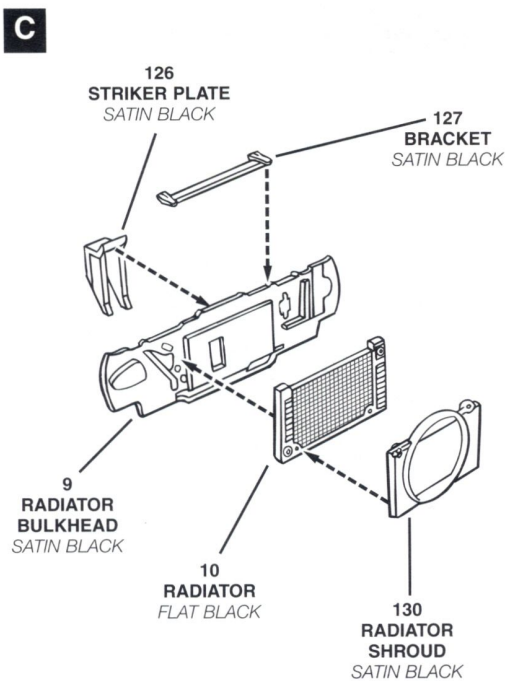

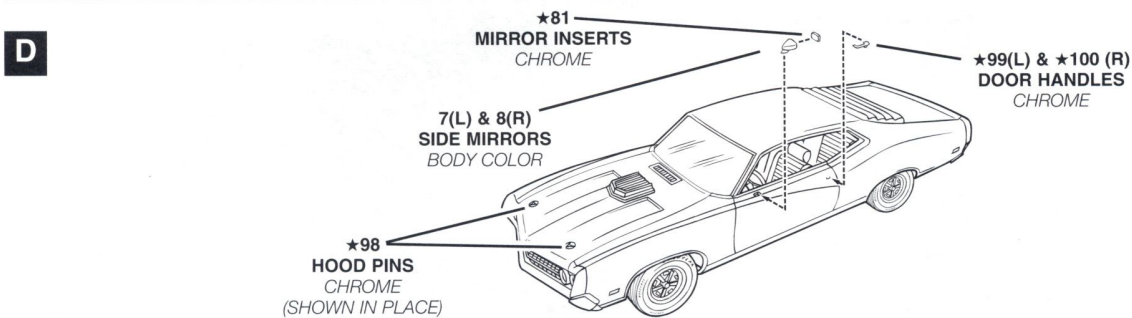
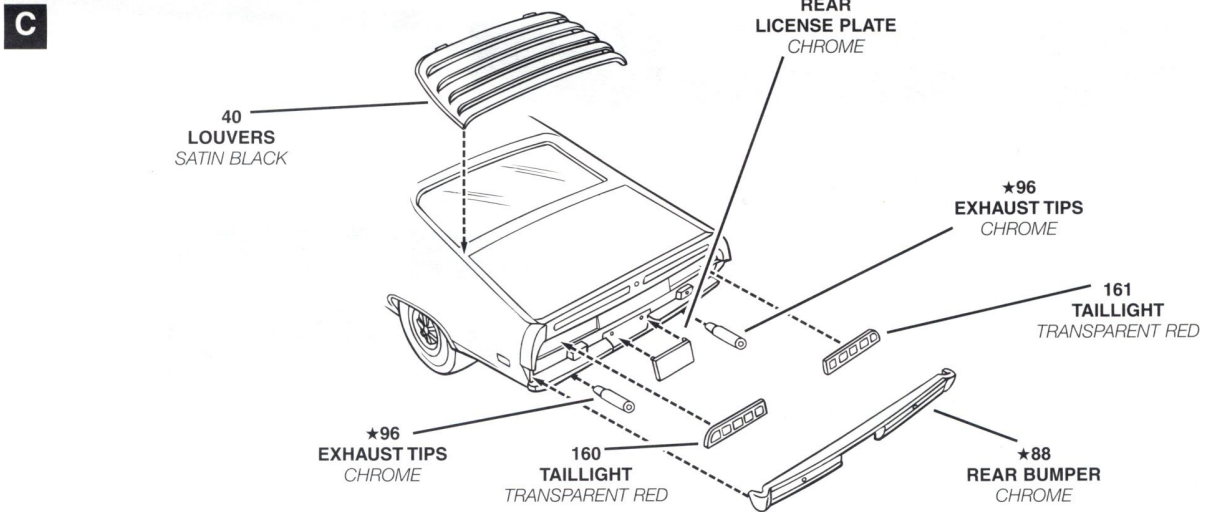
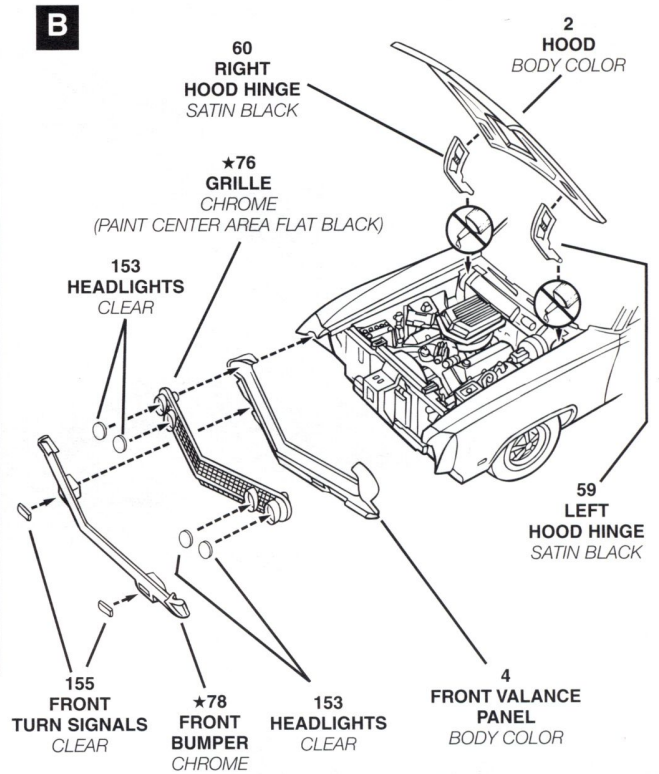
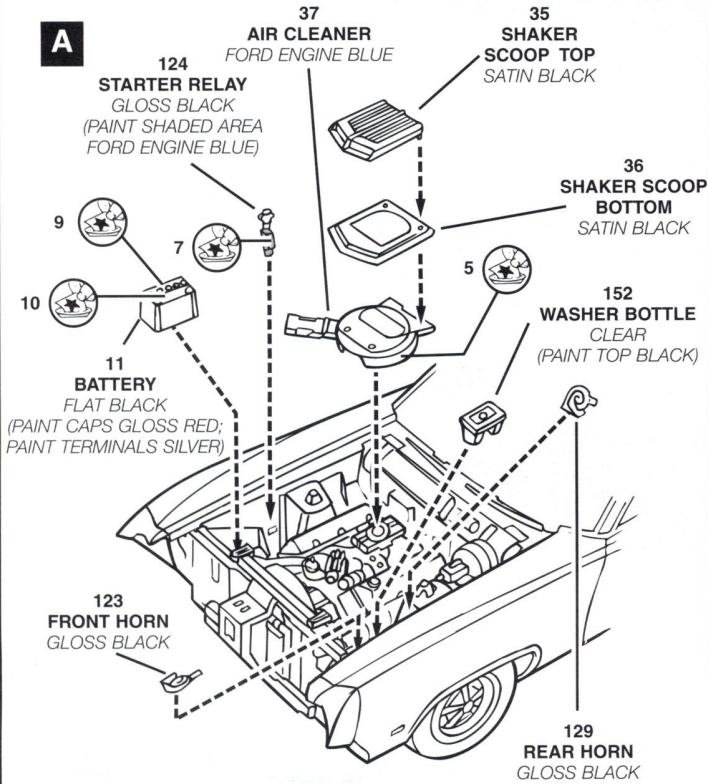

# DECAL PLACEMENT

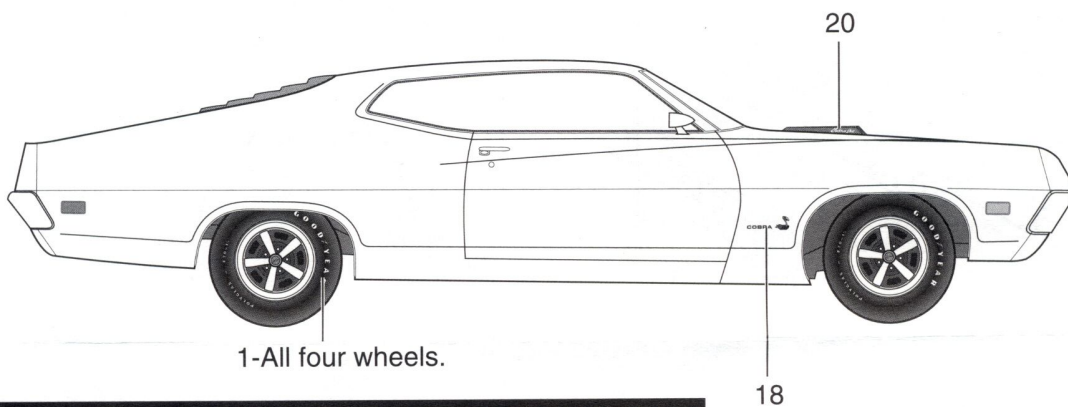
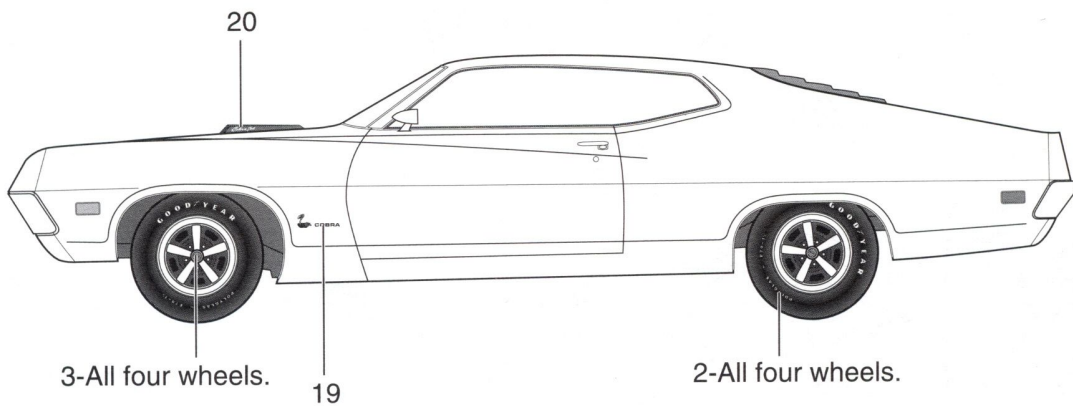

**AFTER PAINTING THE HOOD GLOSS YELLOW, MASK OFF SHADED AREA AS SHOWN BELOW TO PAINT EXPOSED AREA, SATIN BLACK. APPLY DECAL 27 AND 28 AFTERWARDS. (DETAIL FOR EXAMPLE ONLY - MEASUREMENTS ARE CORRECT)**

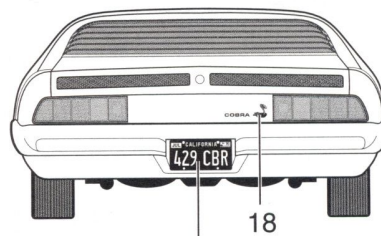
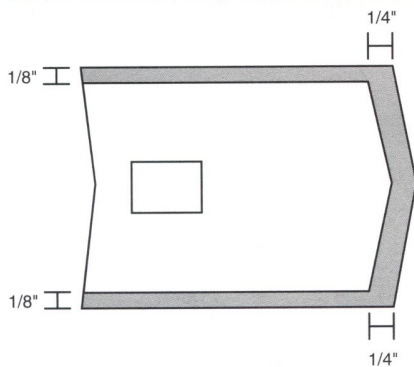

22, 24 or 26  
Use 21, 23 or 25 for front plate.

